

CE INSTRUCTIONS



INSTALLATION / OPERATION / CARE / MAINTENANCE / SAFETY ADVICE

AUTOMATIC SAFETY COVER ROUSSILLON SUBMERGED MODEL

MOTOR IN AXLE
ABOVE WATER DECK

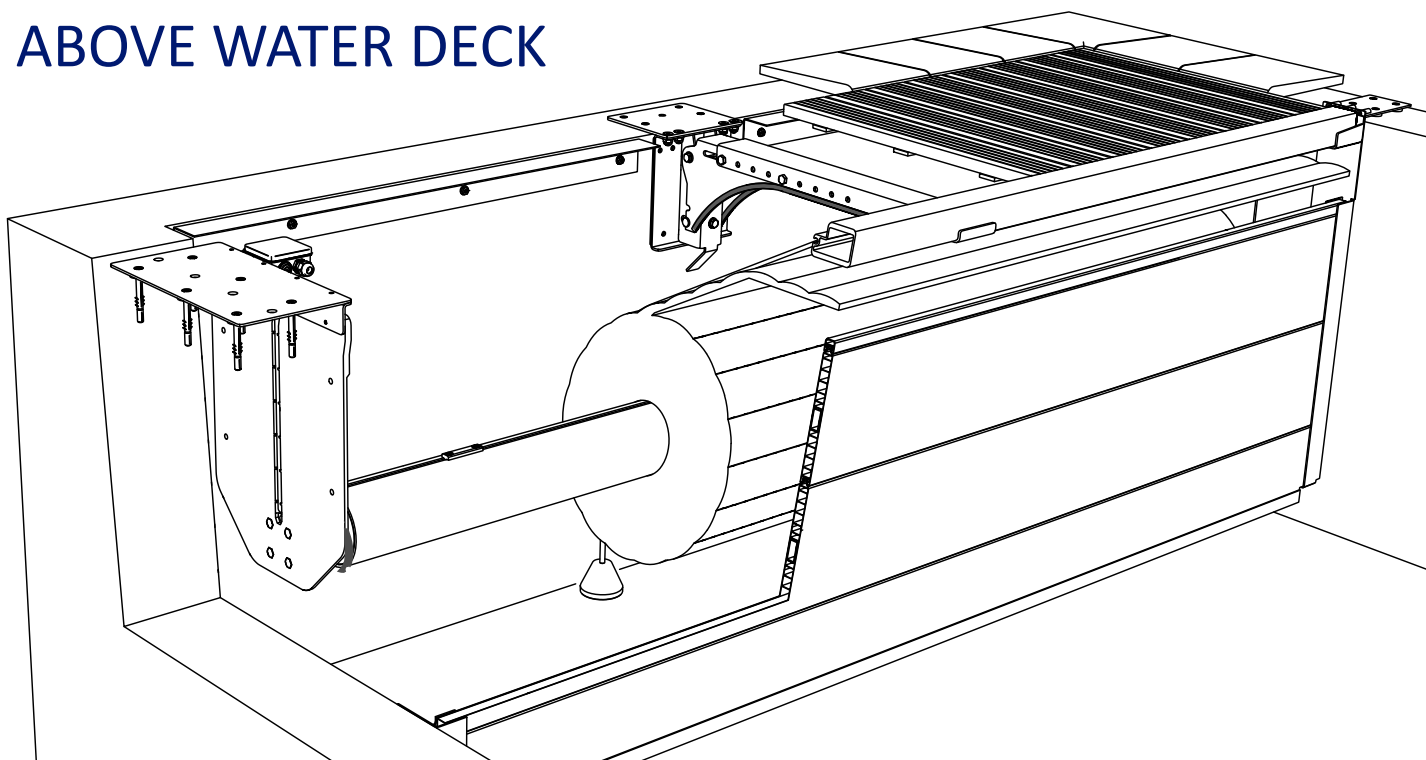

FLUIDRA

NF P 90-308 compliant manufacturing
Read carefully and keep for future reference

FLUIDRA INDUSTRY FRANCE
105 Rue Henry Potez
66000 Perpignan - FRANCE
Tel : 04.68.61.75.30

Series number

Revision index : F-01-2022

- When the safety cover is open and fastened, it should prevent children under the age of 5 entering the pool.
- This cover complies with the NF P 90-308 standard. It is the responsibility of the installer to install it in accordance with this standard.
- This instruction manual is for the use of the installer and must be given to the owner of the pool after installation.
- Electrical installation must comply with current standards, notably NF C 15-100.
- Period of use: all times of year (depending on the geographical location of the pool).
- Average opening and closing time (8m x 4m pool): 2 minutes 30 seconds.
- This cover has been manufactured following accurate measurements taken and included on the purchase order delivered by Fluidra to the installer or retailer.
- The total distance between the edge of the pool and the cover must be less than 70 mm. If it is more than 70 mm it ceases to be compliant with NF P 90-308.
- It is the responsibility of the installer or retailer:
 - To provide an accurate plan of the pool to include measurements of the length and width.
 - To indicate clearly any individual shape (overflow, edges) and to provide a template so that the cover fits the pool perfectly.
- In order to ensure that the cover works correctly, the level of water in the pool must be constant and adjusted to the position of the skimmers. A water level regulator is strongly recommended.

DELIVERY / UNLOADING

- Two persons and/or a handling machine are needed to ensure that the equipment is safely unloaded.
- It is highly advisable to check the package in the presence of the installer/retailer and if necessary to note any concerns on the delivery note, making sure to indicate specific details (for example: scratches on slats, etc.).
- We cannot be held responsible for any losses or damage caused during transport. Our goods are sold ex works Fluidra Industry, France.
- The slats should be unloaded directly onto the water and care should be taken to ensure they do not rub against the ground. If this is not possible, they should be stored in the shade until installation is possible. Failure to respect this instruction will cause permanent damage to the slats and render the guarantee void.

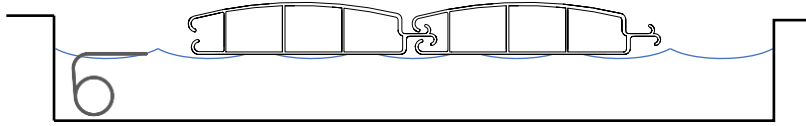
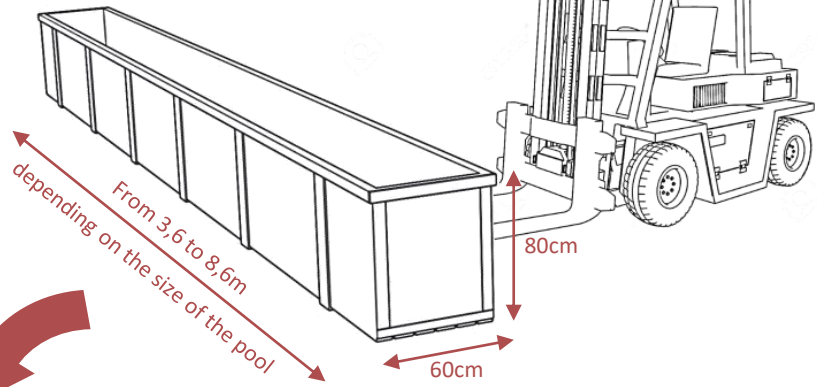
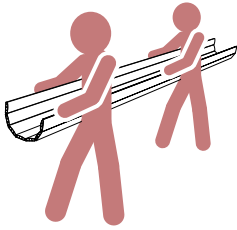

NECESSARY TOOLS

 $\varnothing 8$ $\varnothing 10$ $\varnothing 12$				
 10 m				
 N°3 N°4 N°5 N°6	 T25 T30 T40	 10 mm 13 mm 17 mm		

ASSEMBLY



Safety brackets :

- Fabrics / stainless steel / ABS
- On flat / on wall

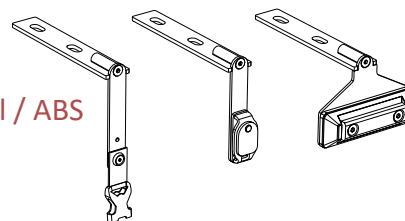

Universal electrical panel:

Compatible with all Fluidra motors
Integrated remote control receiver.

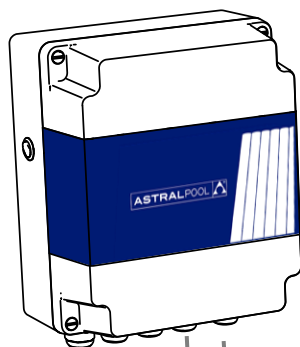

Key-operated switch:



Connection box:

Insulating gel

Anti-bending bracket(s):

Optional

- 650-1080mm
- 1080-1500mm
- Wall mounting
- Flat mounting

Grating :

- On square
- On level surface

Cover:

Strips of 7 blades

- PVC
- Polycarbonate

Fastening :

- Wall mounting
- Flat mounting

Flanges:

- Plastic (ABS)
- Stainless steel

Axle:

- Aluminium Ø146mm
- Aluminium Ø196mm

Motor :

- 120 Nm
- 250 Nm
- 500 Nm

Bags of screws:



Beam:

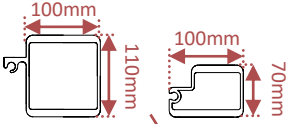

Gratings :

- Wood
- Aluminium

Beam boxes (x2):

- Adjustable wall mounting
- Adjustable flat mounting

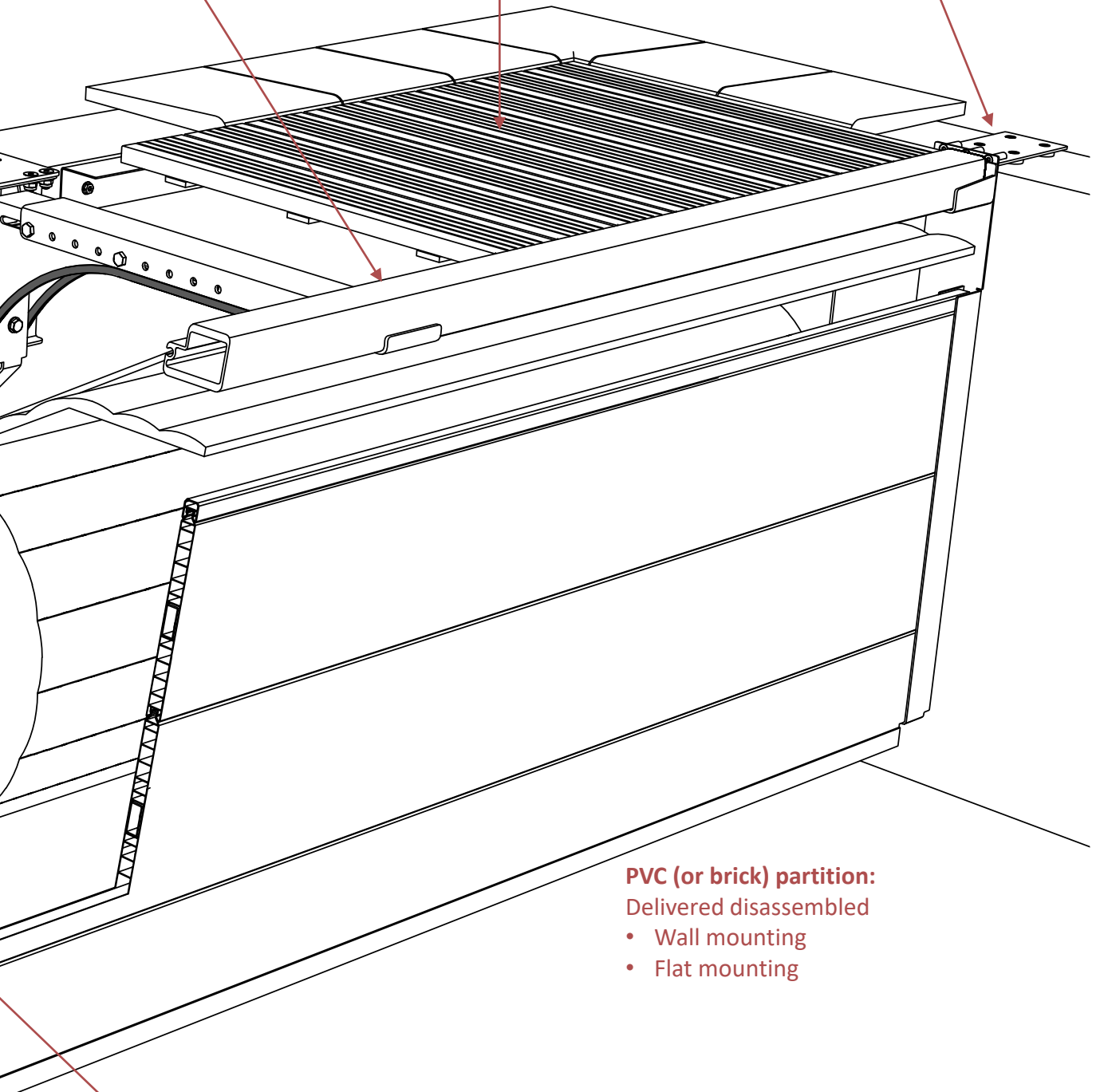

PVC (or brick) partition:

Delivered disassembled

- Wall mounting
- Flat mounting

Straps & counterweights

All of the components of the above-ground roller attached to the recess can be removed without removing the coping:

Works if horizontally or vertically hung.

Anti-bending bracket(s)

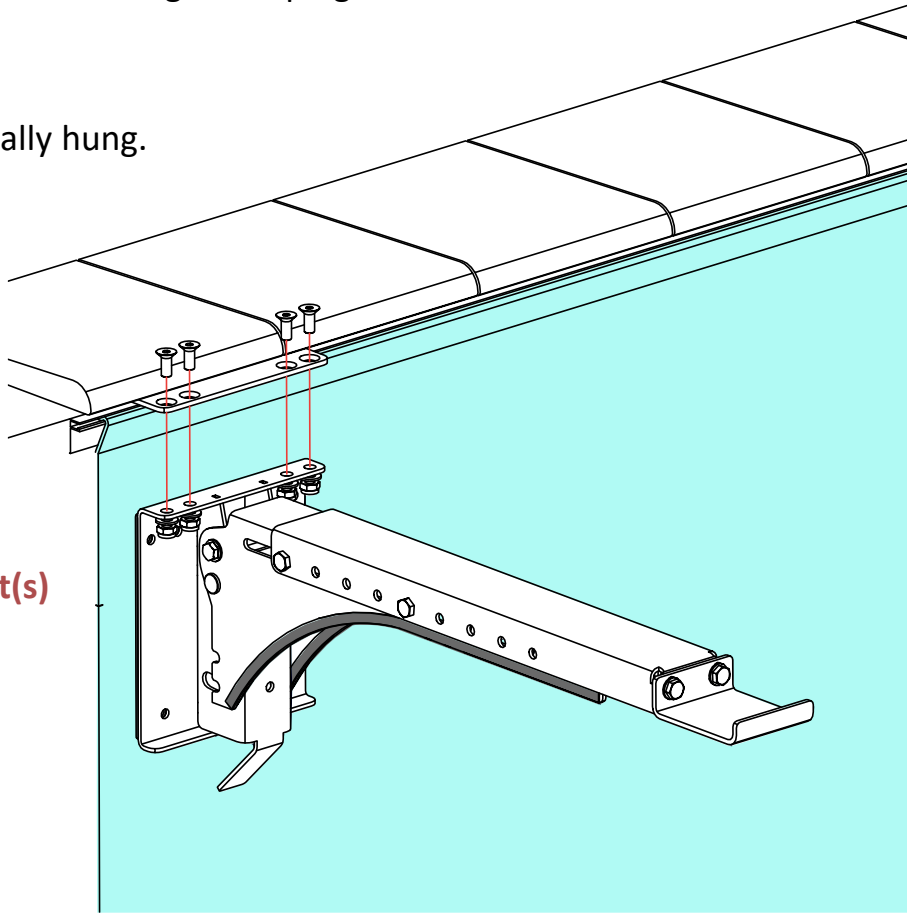

Safety brackets

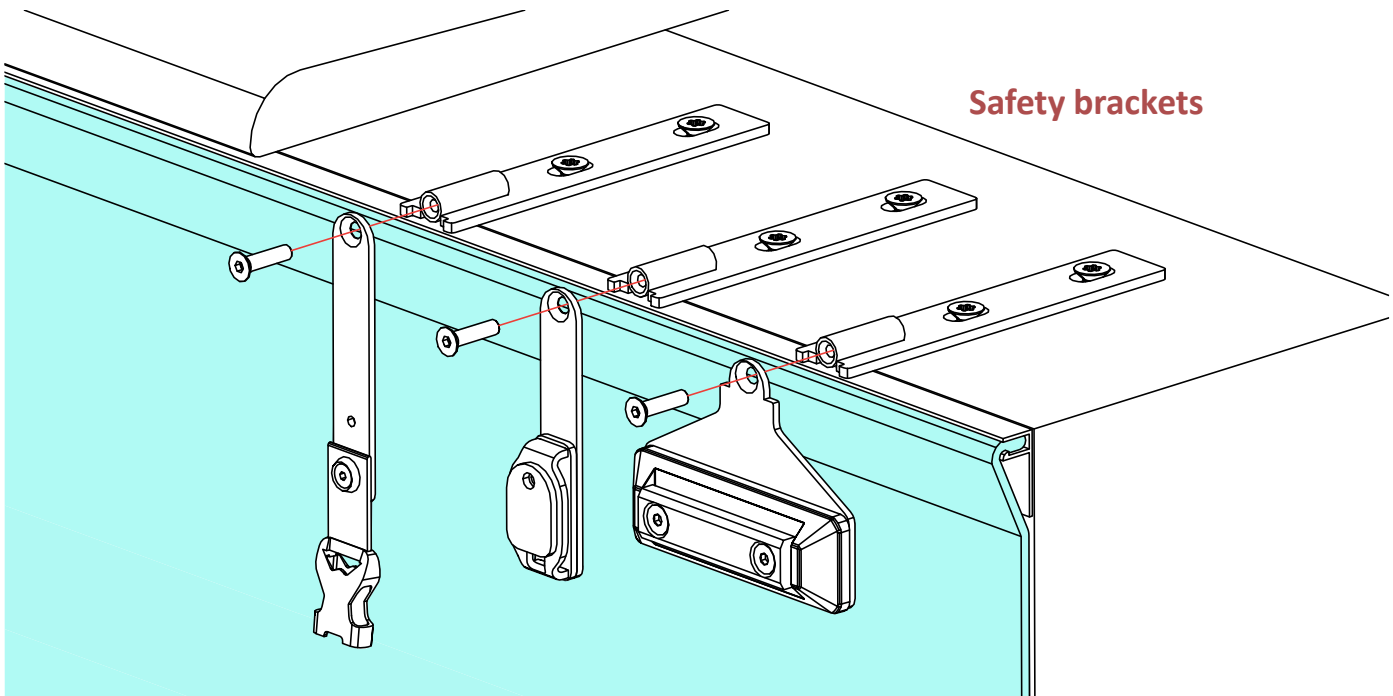

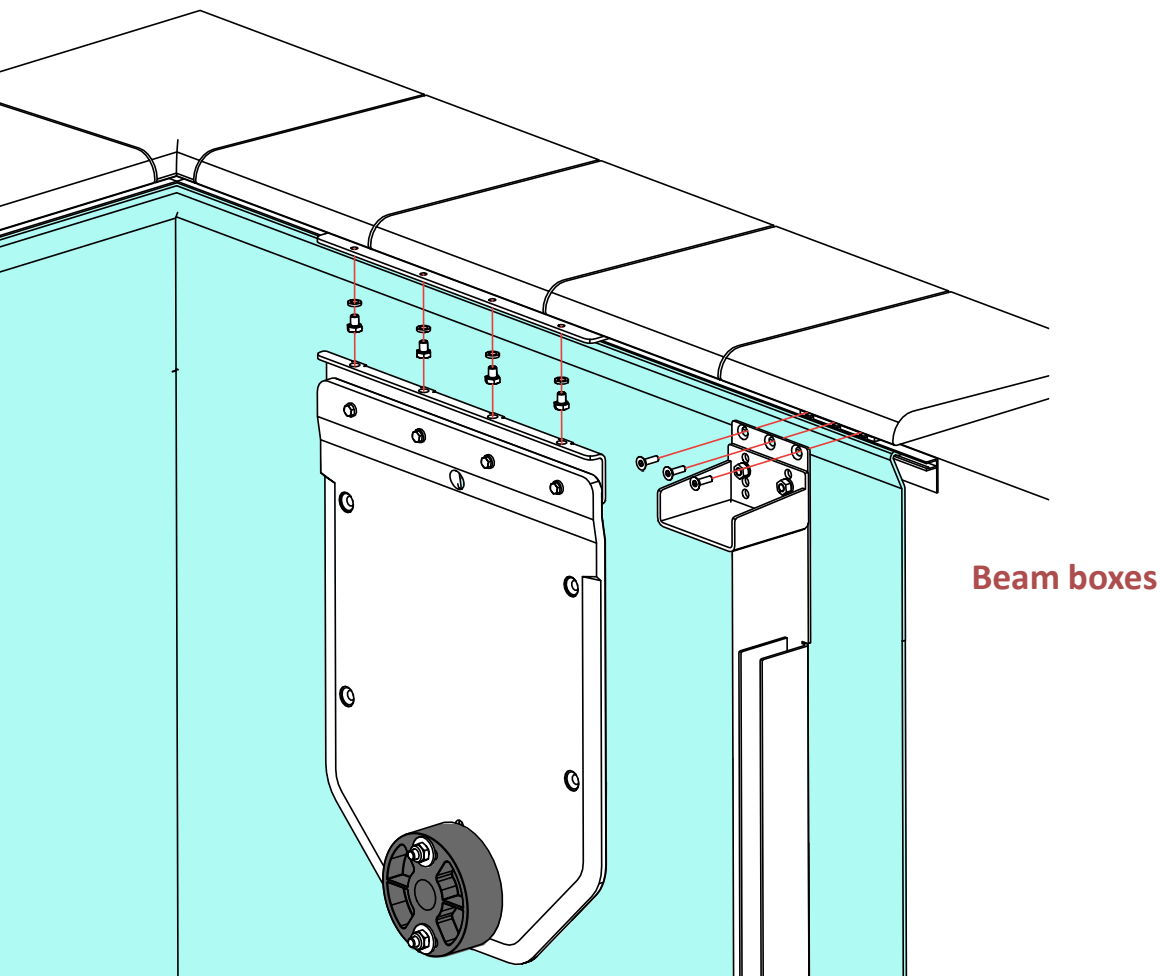

Flanges
Plastic (ABS)
Stainless steel

Partition support

Also works with single beam supports.

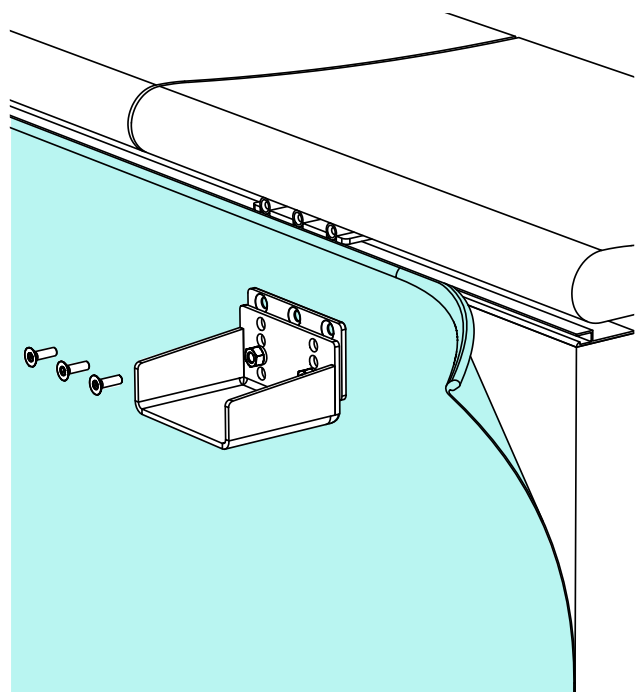

Bracket-mounting
only.

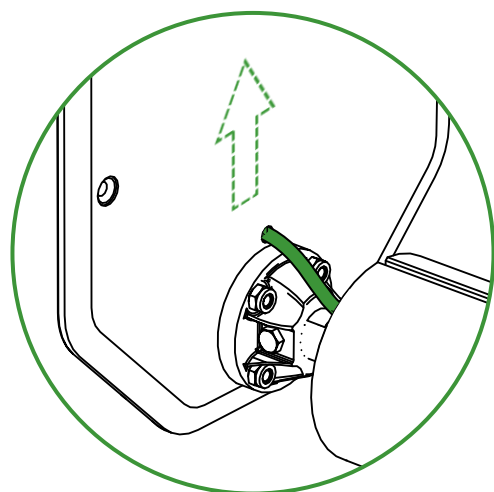
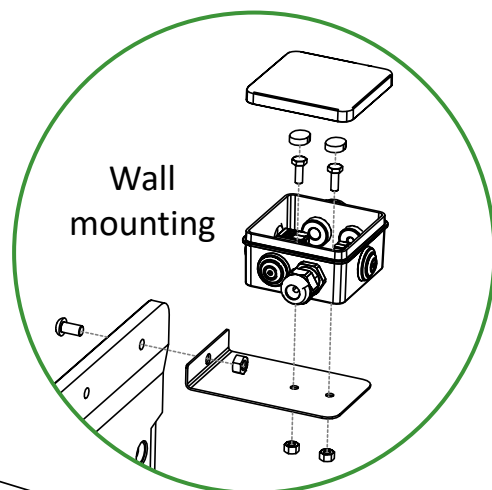
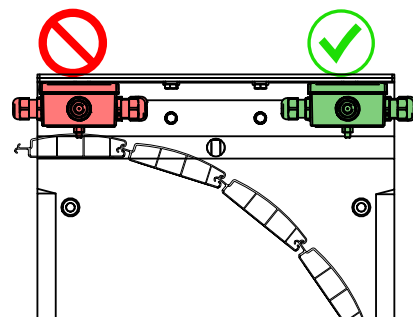

Tighten the motor cable.

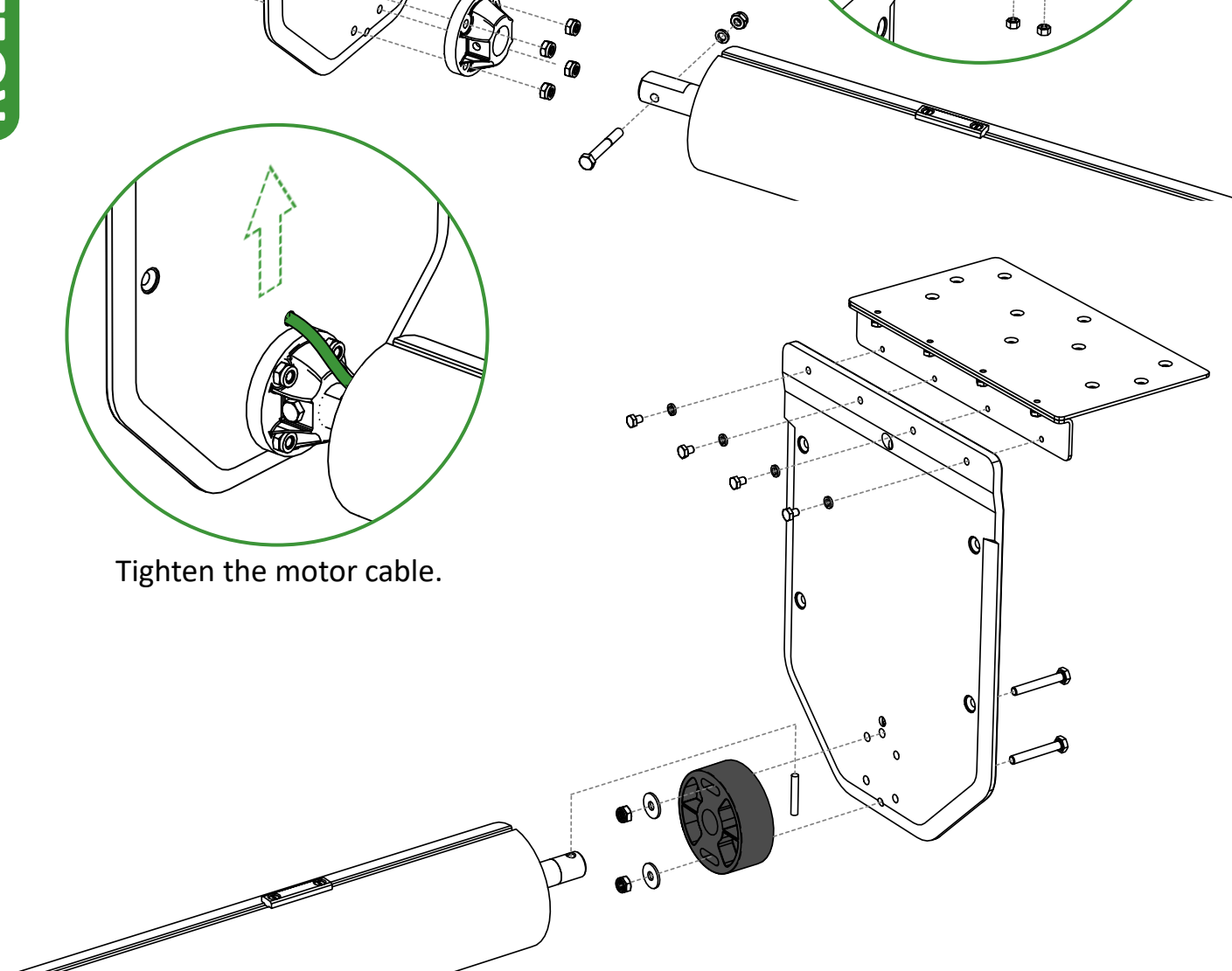

Bracket-mounting
only.

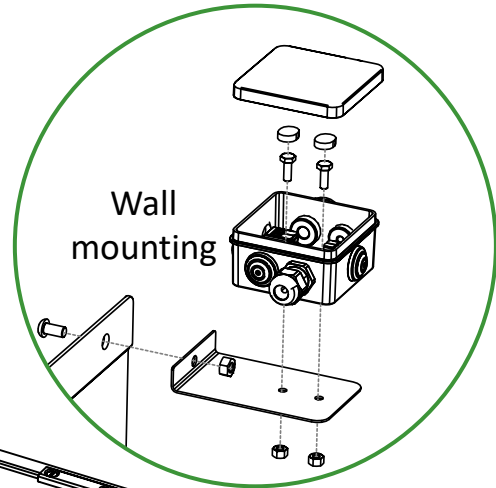
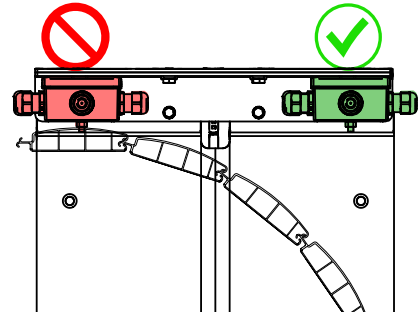
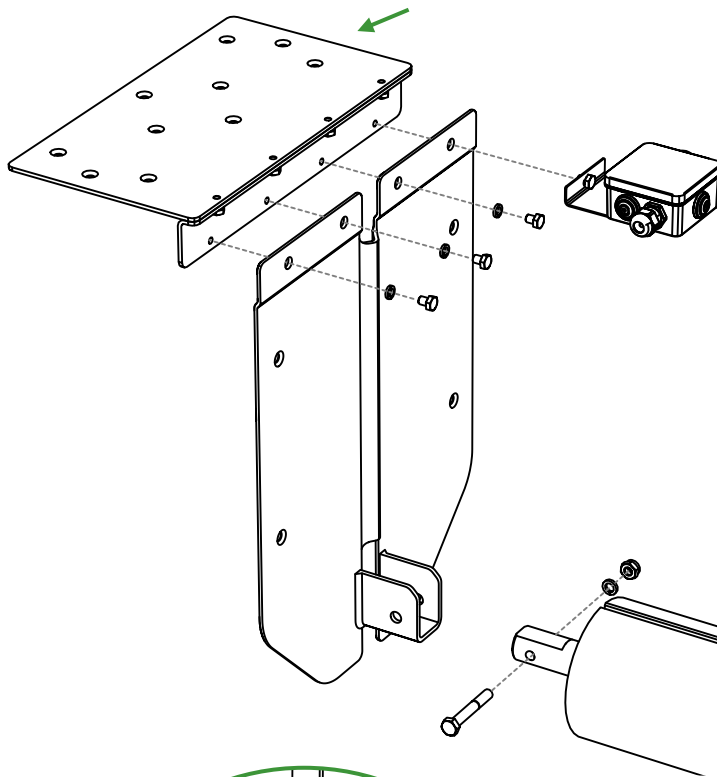

Wall
mounting

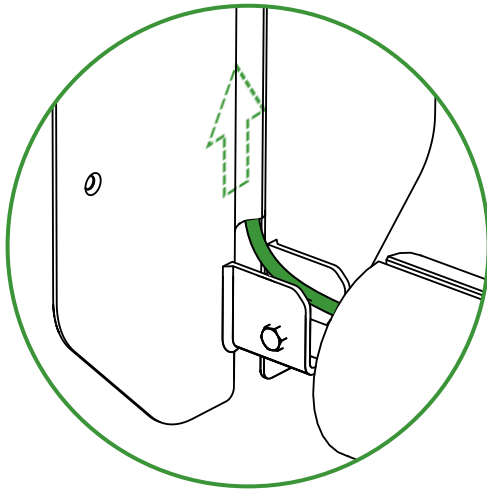

Tighten the motor cable.

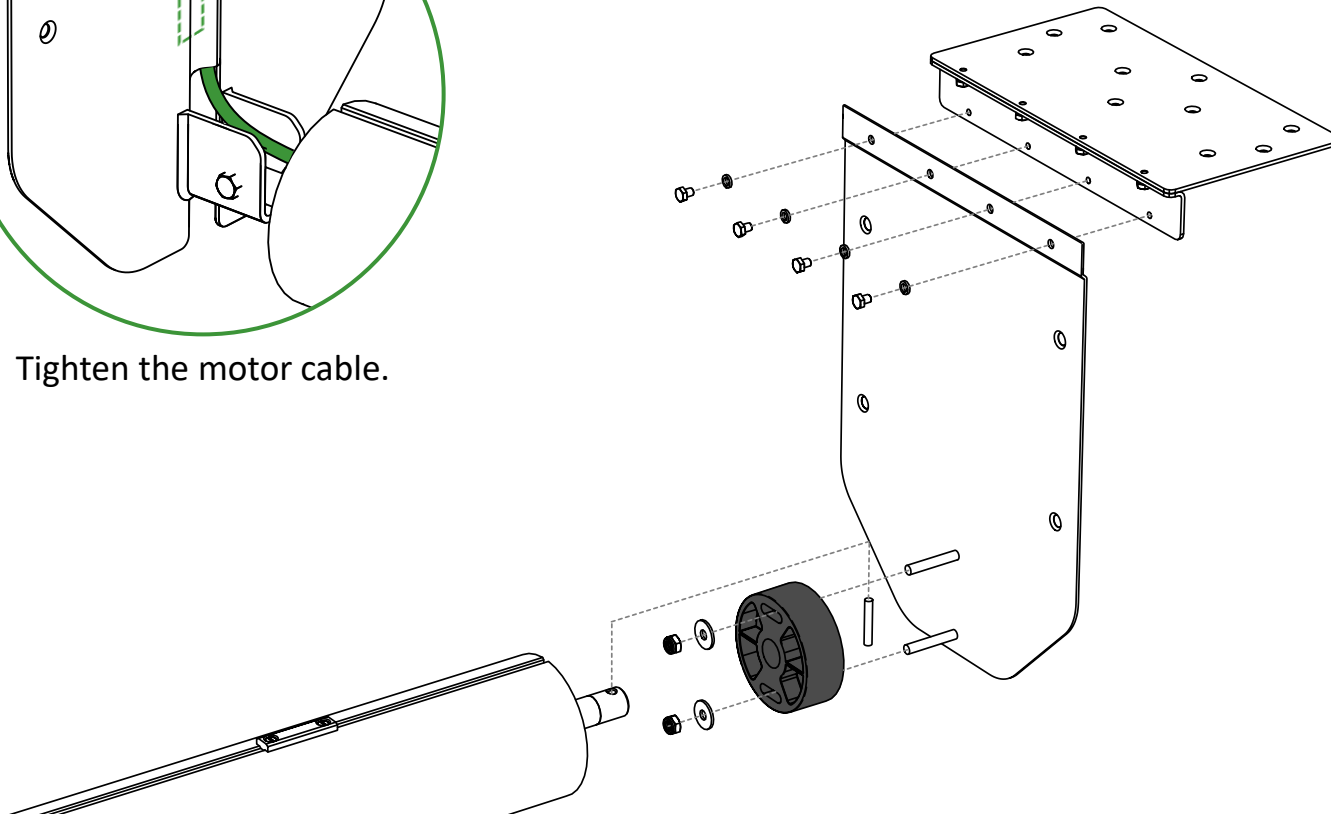

POSITION

1

MOTOR SIDE

Mark the position of the roller.

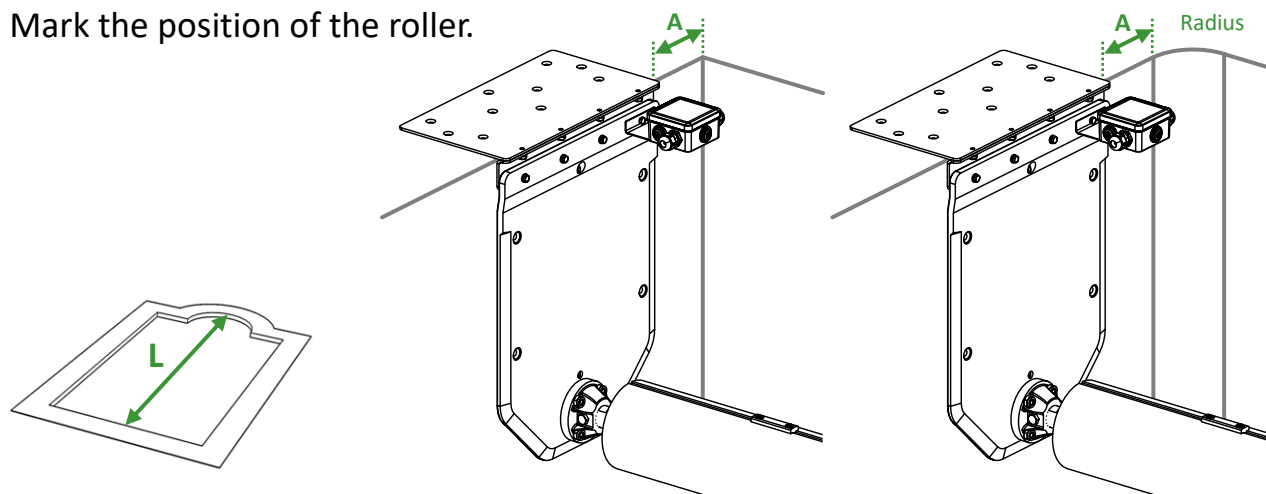

L (m)	6	7	8	9	10	11	12	13	14	15	16	17	18	19	20
A (cm)	12	13	14	16	17	18	19	20	21	22	23	24	25	26	26

2

BEARING SIDE

Mark the position of the roller and make sure it is perpendicular to the edges of the pool.

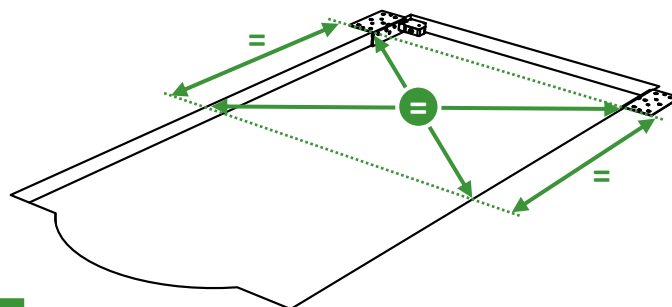

ROLLER INSTALLATION

Loosen the ring and retract the telescopic shaft on the bearing side to prime the roller.

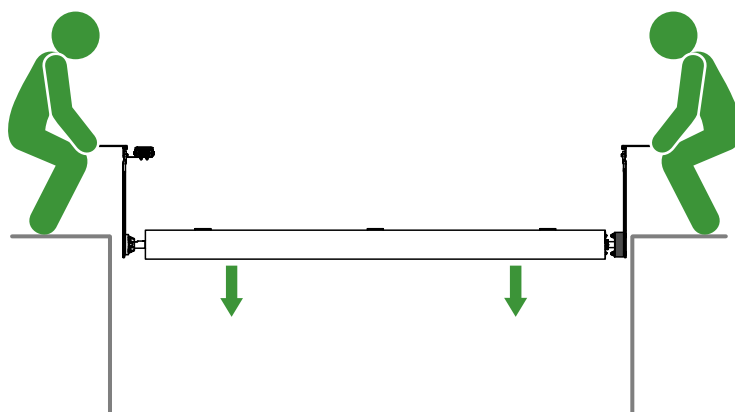
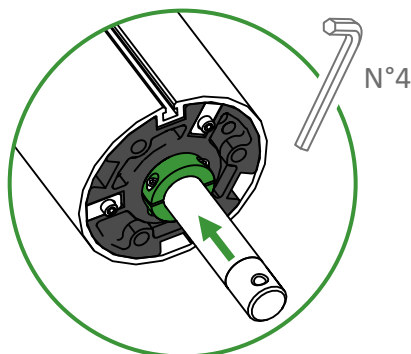

If necessary, adjust the level using the supplied spring wedges.

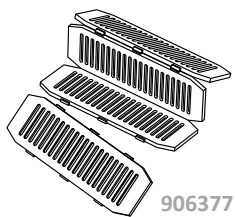

Extend the telescopic shaft on the bearing side to press the flanges against the walls and then tighten the ring.

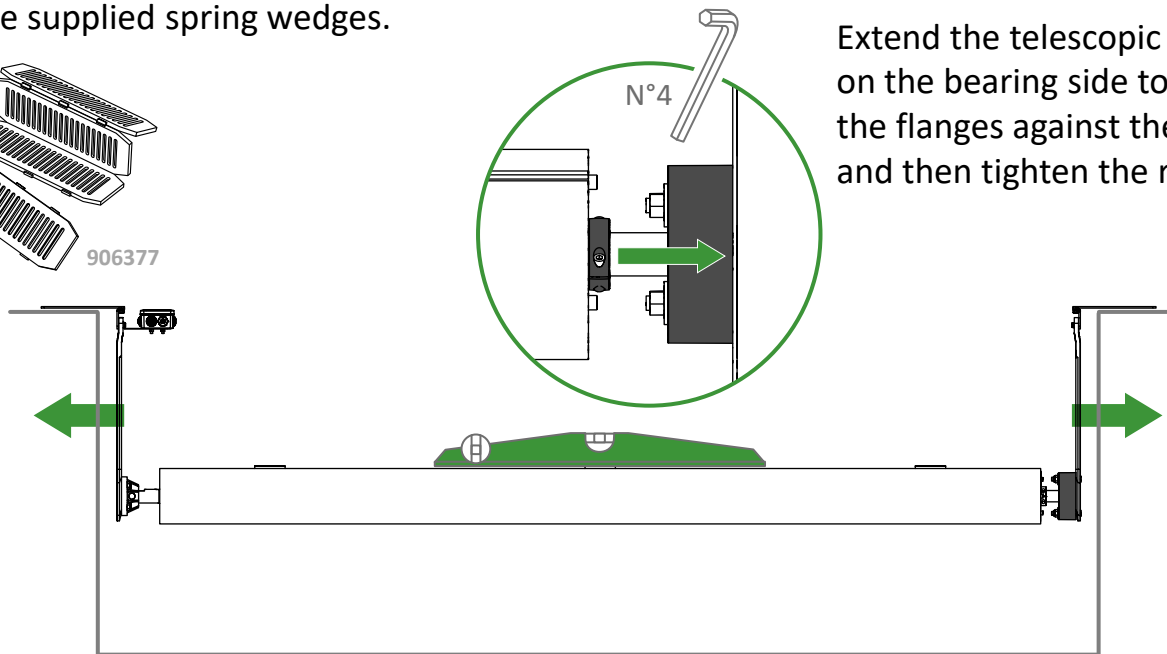

ON FLAT

ON WALL

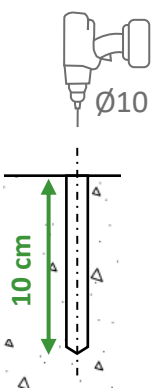

Holder for horizontal mount

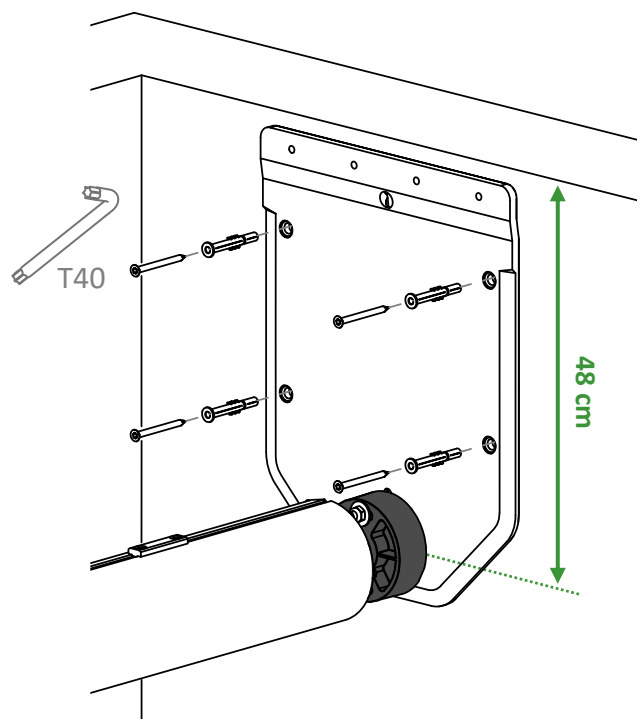
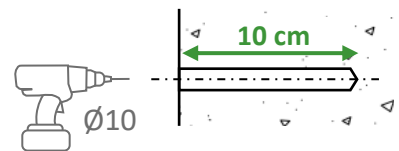
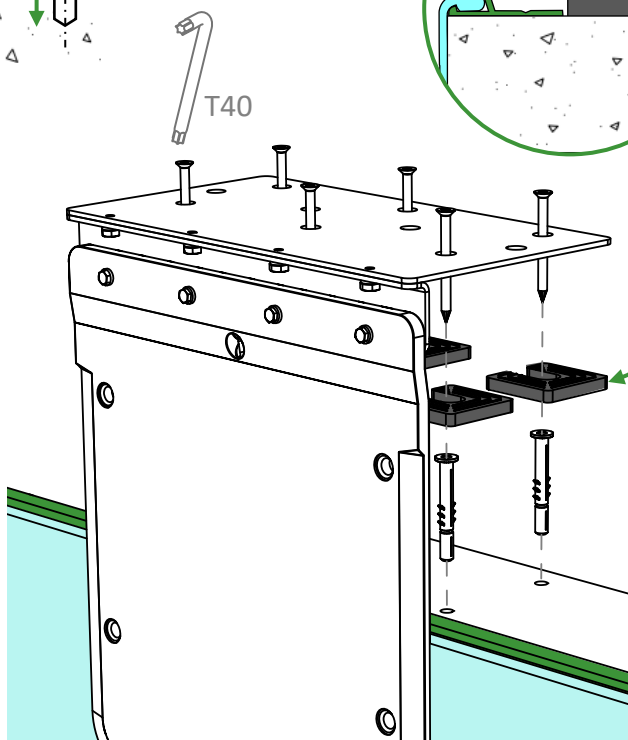
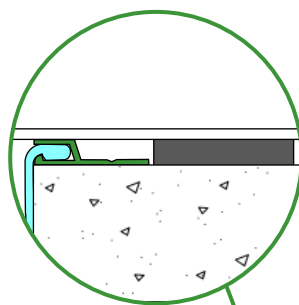

POSITION

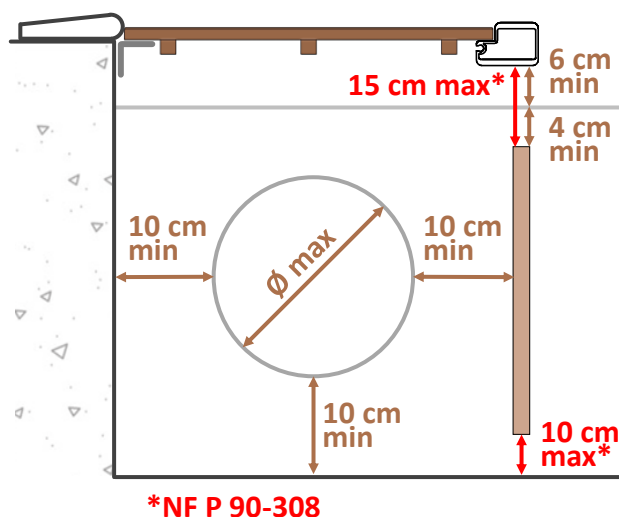

- Observe the recommended dimensions.
- Preferably use the layout diagram if it is provided with the order.
- The position of the different components can be recalculated on the following website: <https://client.fluidrasurmesure.fr>
- Heading Our utilities / Access utilities.
- Calculate the dimensions of the gratings and roller pit.



Pool length (m)	3	4	5	6	7	8	9	10	11	12	13	14	15	16	17	18	19	20
Ø max (cm)	34	37	40	43	46	48	51	53	55	58	60	62	64	65	67	69	71	72

GRATINGS

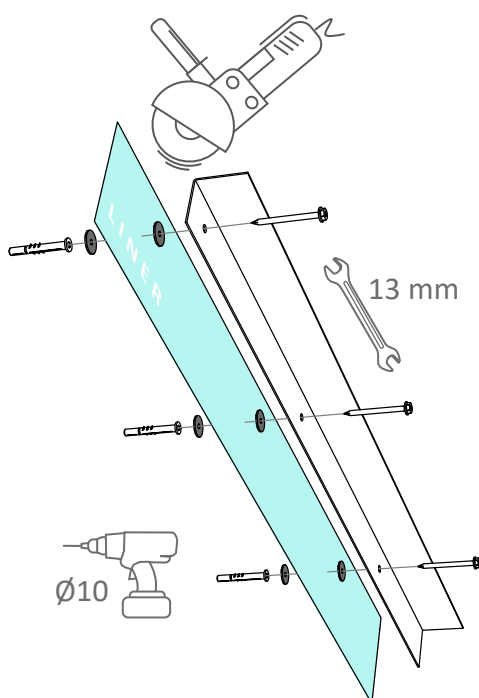
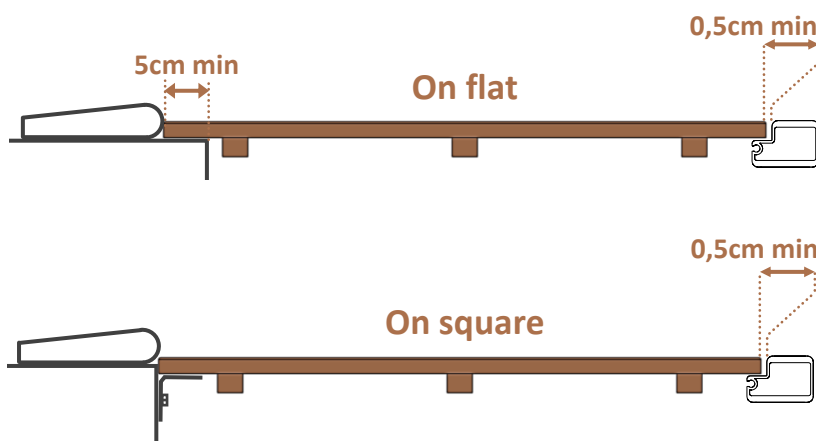

- Cut the square(s) to the width of the pool (gross length: 2.5 m).
- Deburr the cut area to avoid piercing the liner.
- Leave room for reservations without squares (30 cm) at the locations of any anti-bending brackets
- Take the necessary precautions to avoid any oxidation at the cut (new cutting disc, passivation or anti-rust).

Partition required in compliance with standard NF P 90-308

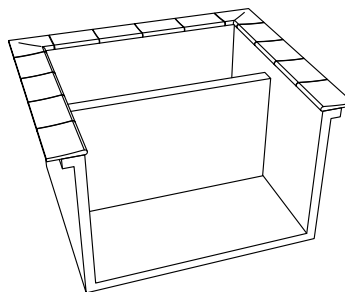

WITH LINER

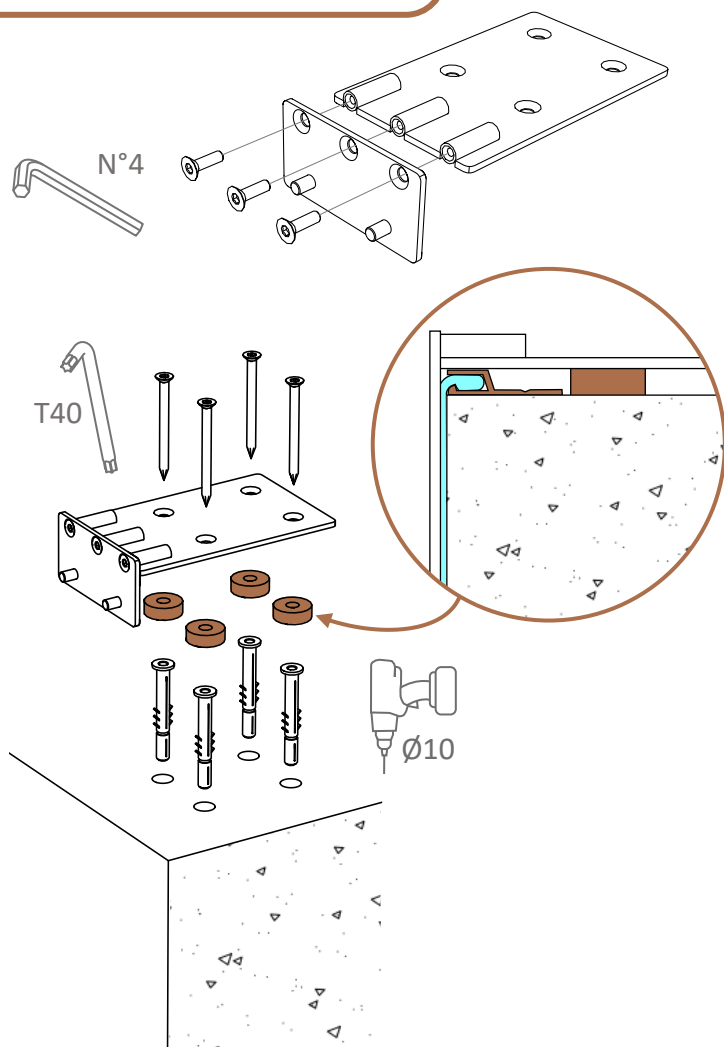

WITHOUT LINER

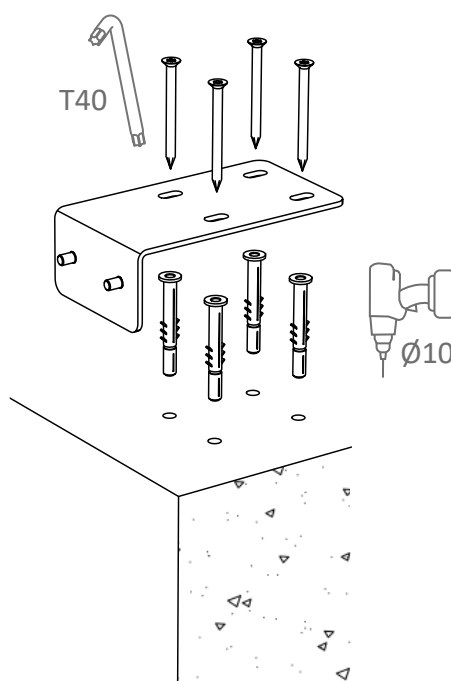

BEAM BOXES

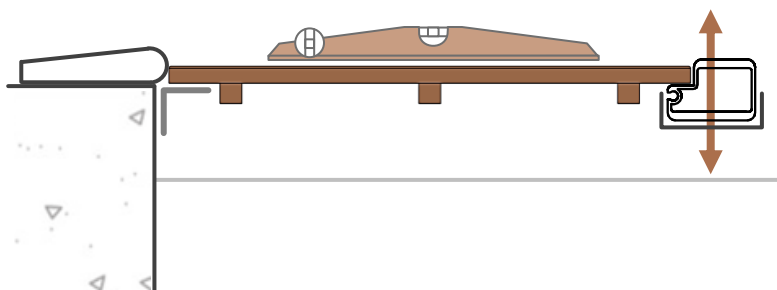
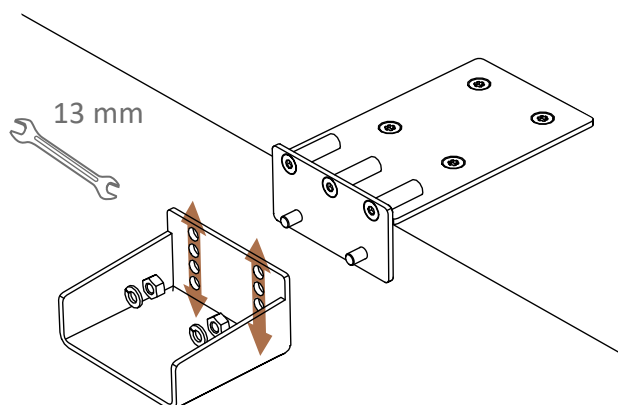

PVC PARTITION

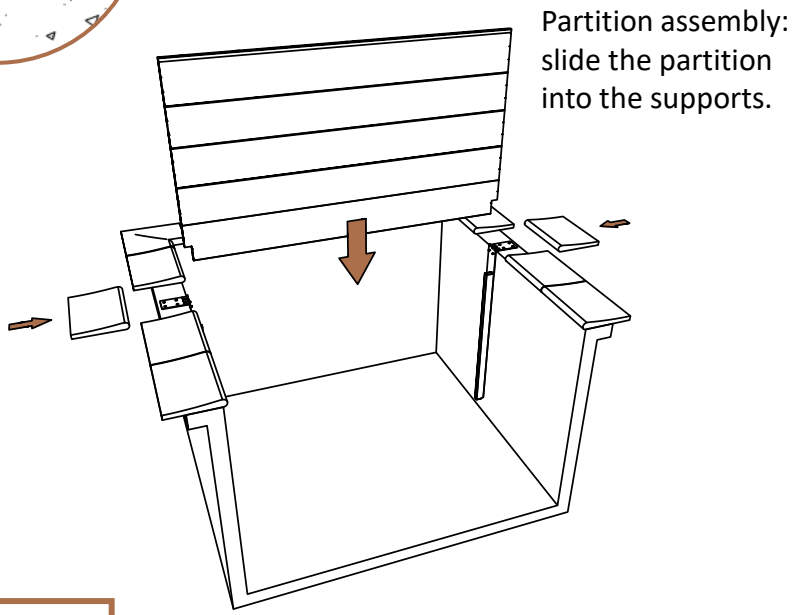
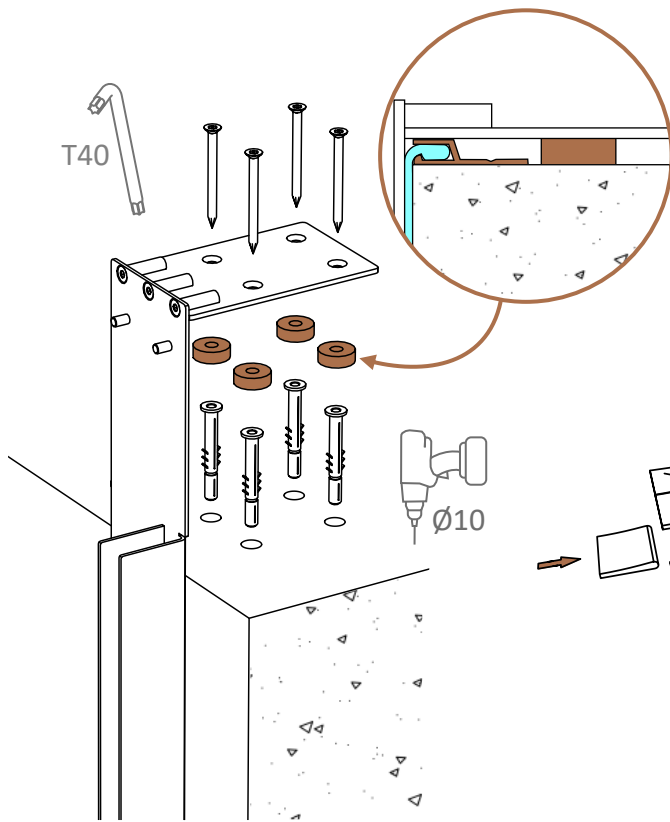
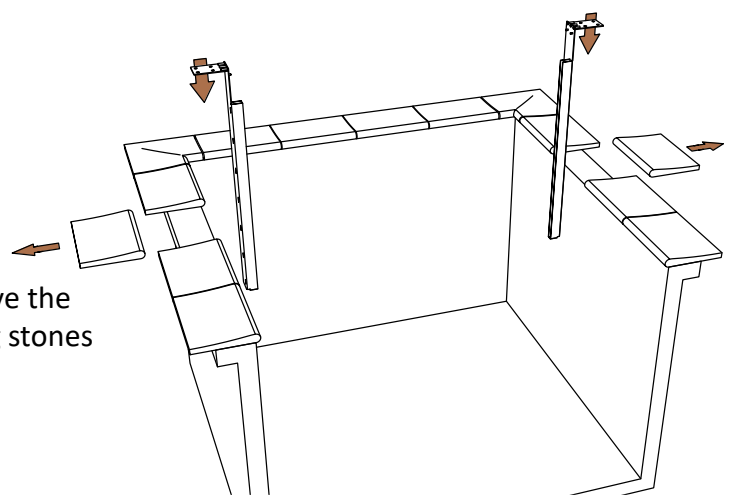
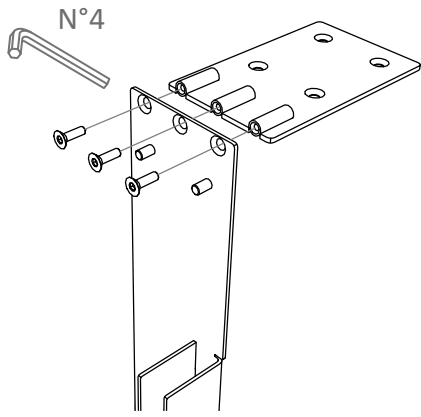

BEAM BOXES

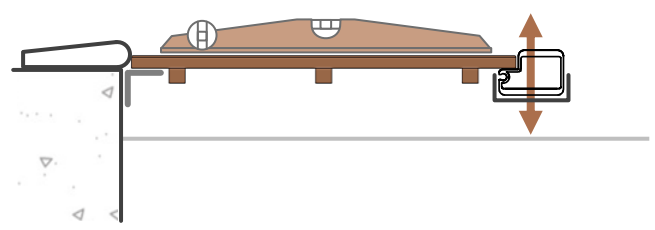
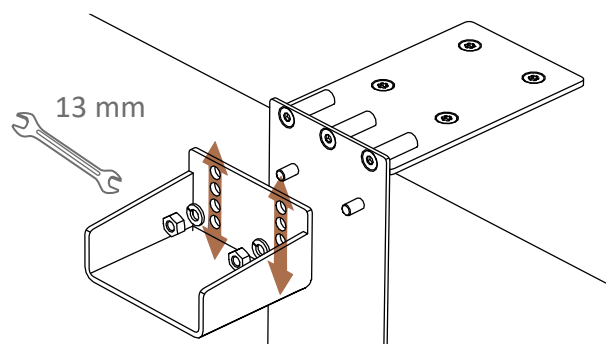

PVC PARTITION

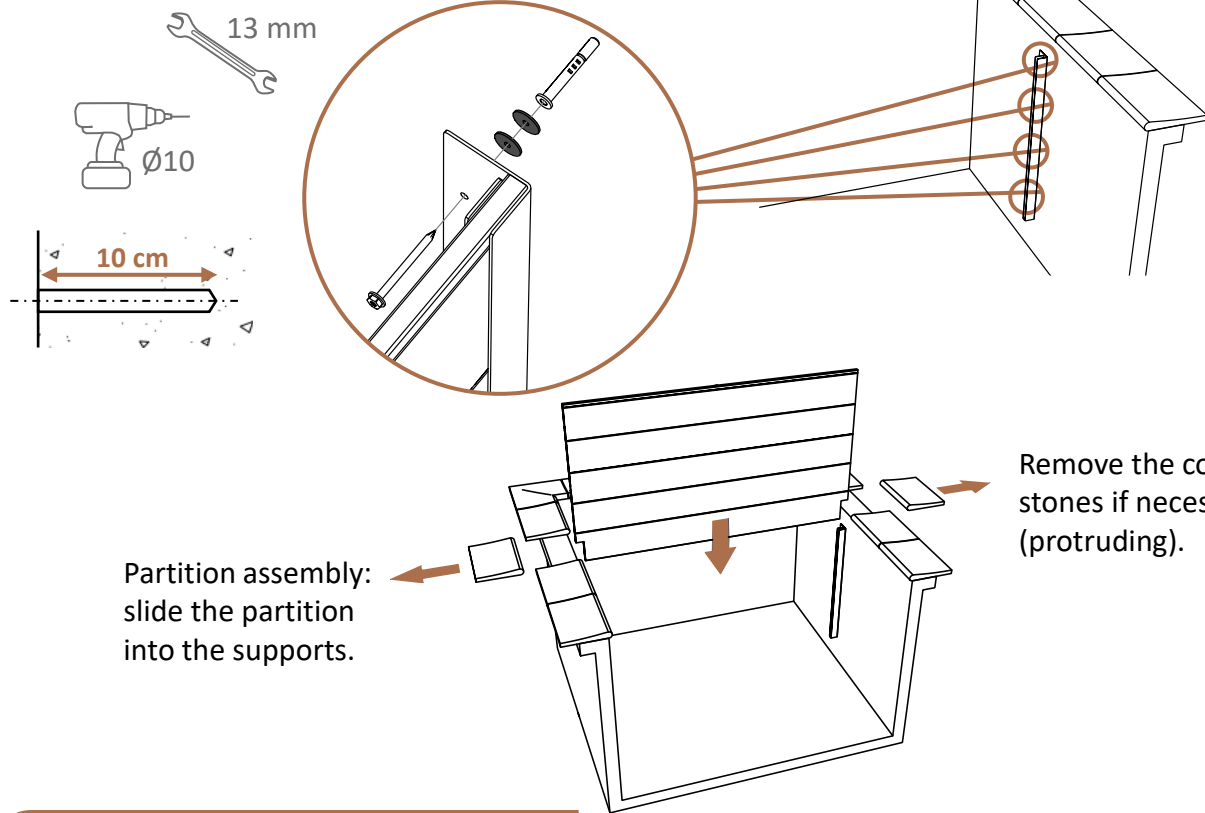

BEAM BOXES

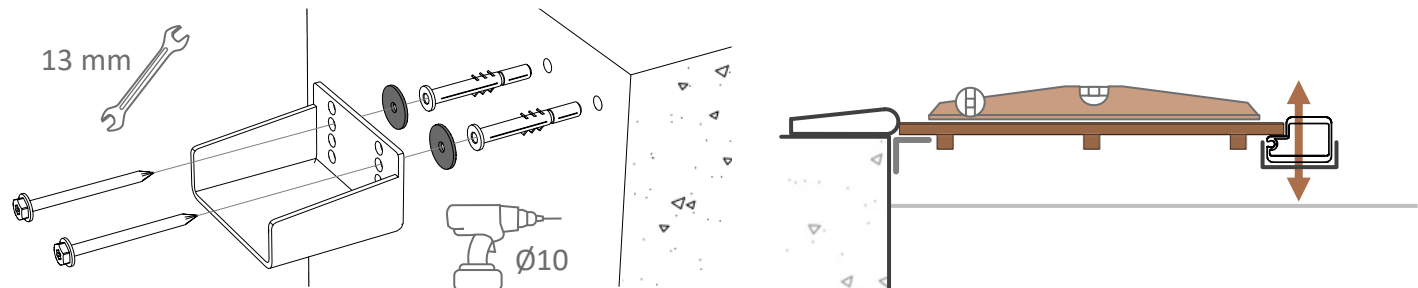

STRAPS & COUNTERWEIGHTS

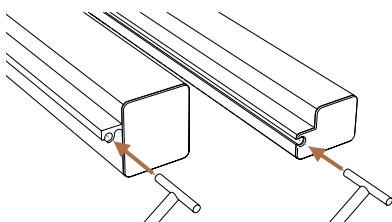

	Quantity
$L \leq 3 \text{ m}$	2
$3 \text{ m} < L \leq 5 \text{ m}$	3
$5 \text{ m} < L \leq 7 \text{ m}$	4
$L > 7 \text{ m}$	5

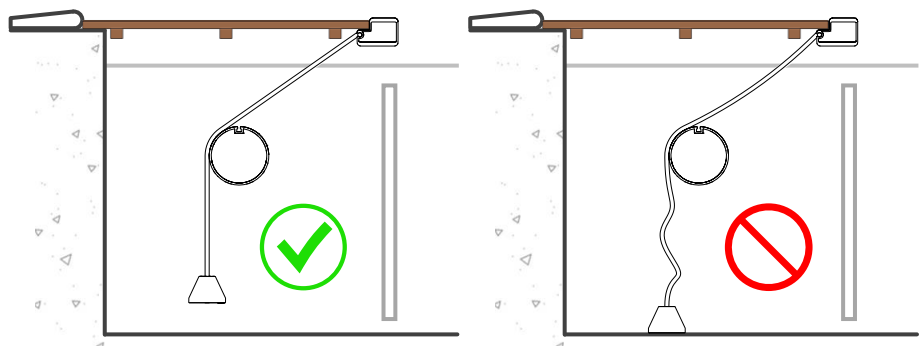

ANTI-BENDING BRACKET

- 1 anti-bending bracket : in the centre
- 2 anti-bending bracket : spaced at L/4
- 3 anti-bending bracket : spaced at L/8
- Two extensions depending on the size of the gratings:
 - $650 < X < 1080$ mm
 - $1080 < X < 1500$ mm

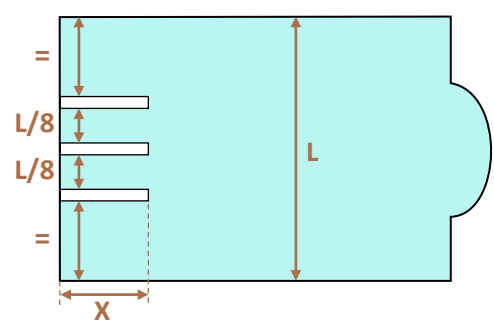

- The anti-bending bracket can be wall- or surface level-mounted:

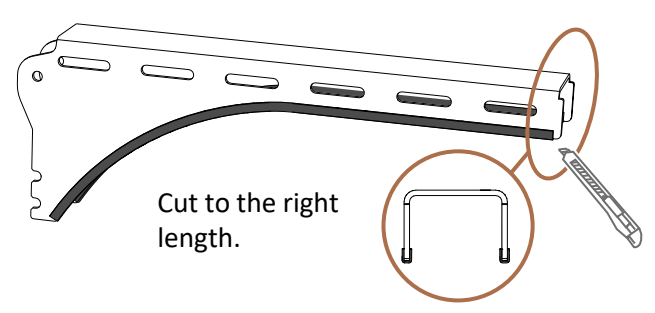
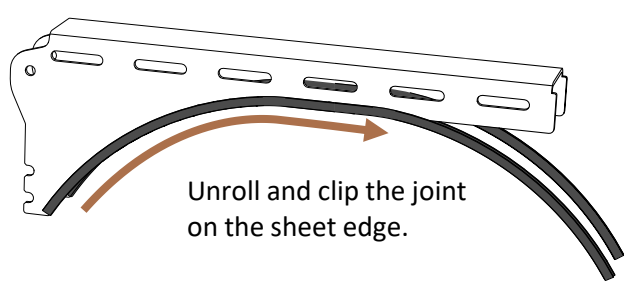
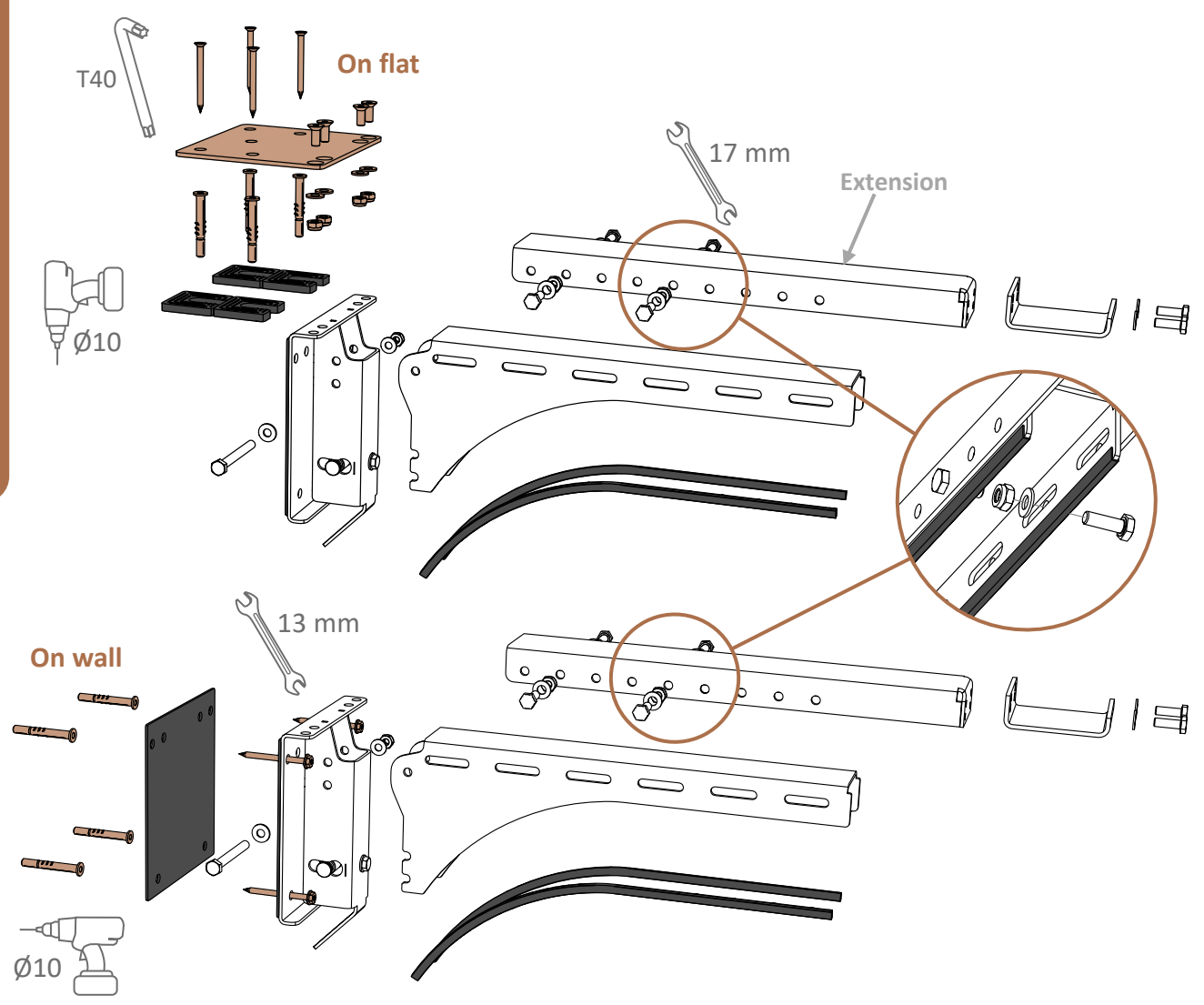

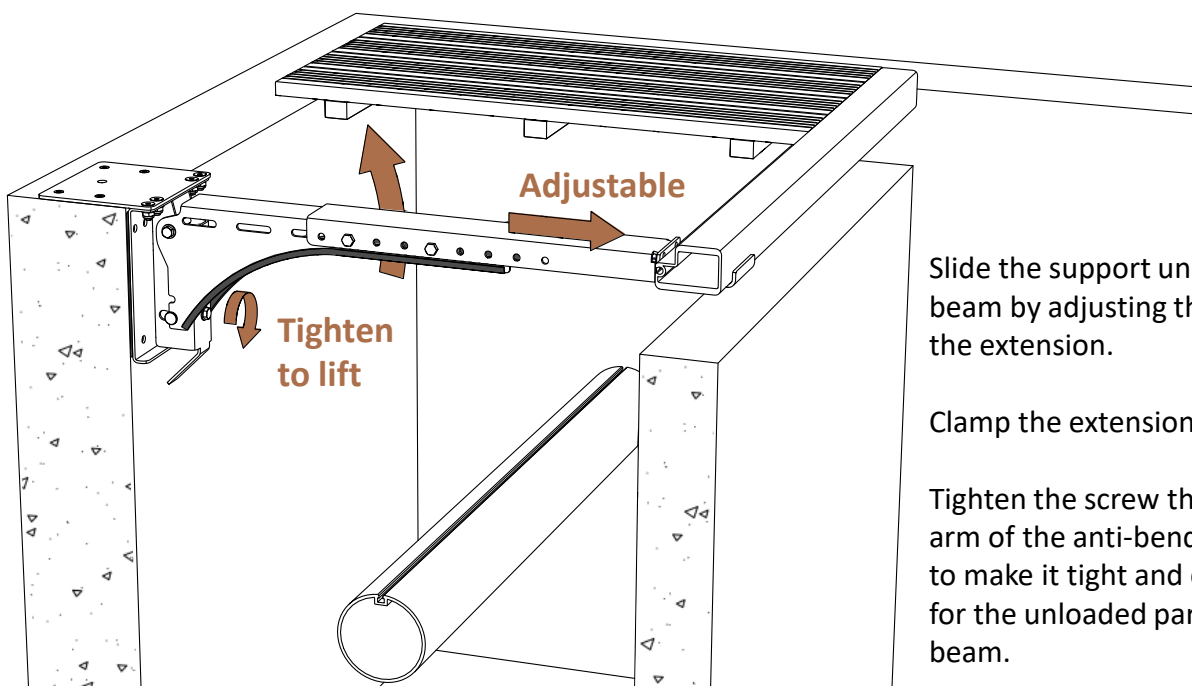
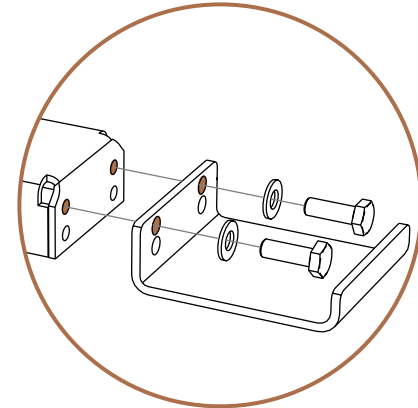
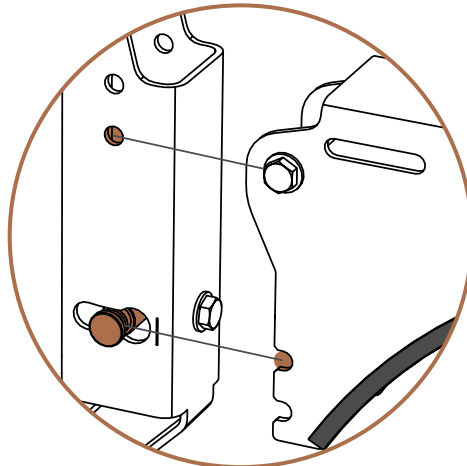
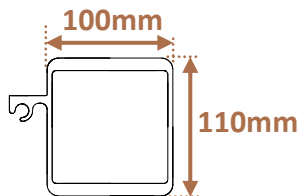
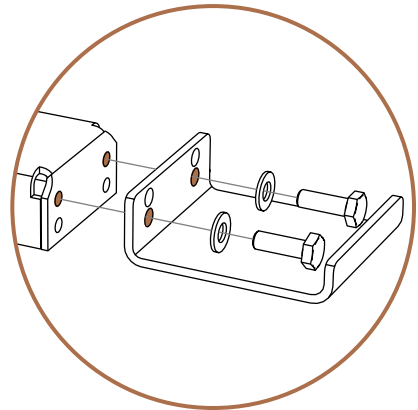
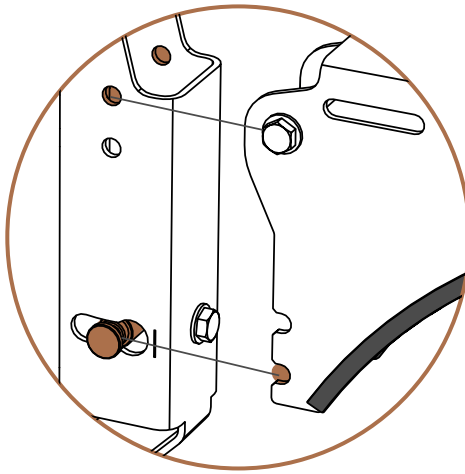
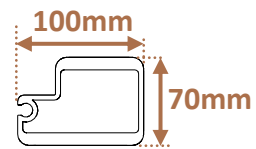

Slide the support under the beam by adjusting the length of the extension.

Clamp the extension in position.

Tighten the screw that lifts the arm of the anti-bending bracket to make it tight and compensate for the unloaded part of the beam.

CONNECTING OF SLATS

- The straps must be attached when the limit switches are being set.
- The slats should go down from the front of the roller.
- If there are skimmers along the length of the pool we would advise you to replace the flanges provided with 2mm stainless steel flanges to prevent the slats becoming blocked.



COVER INSTALLATION

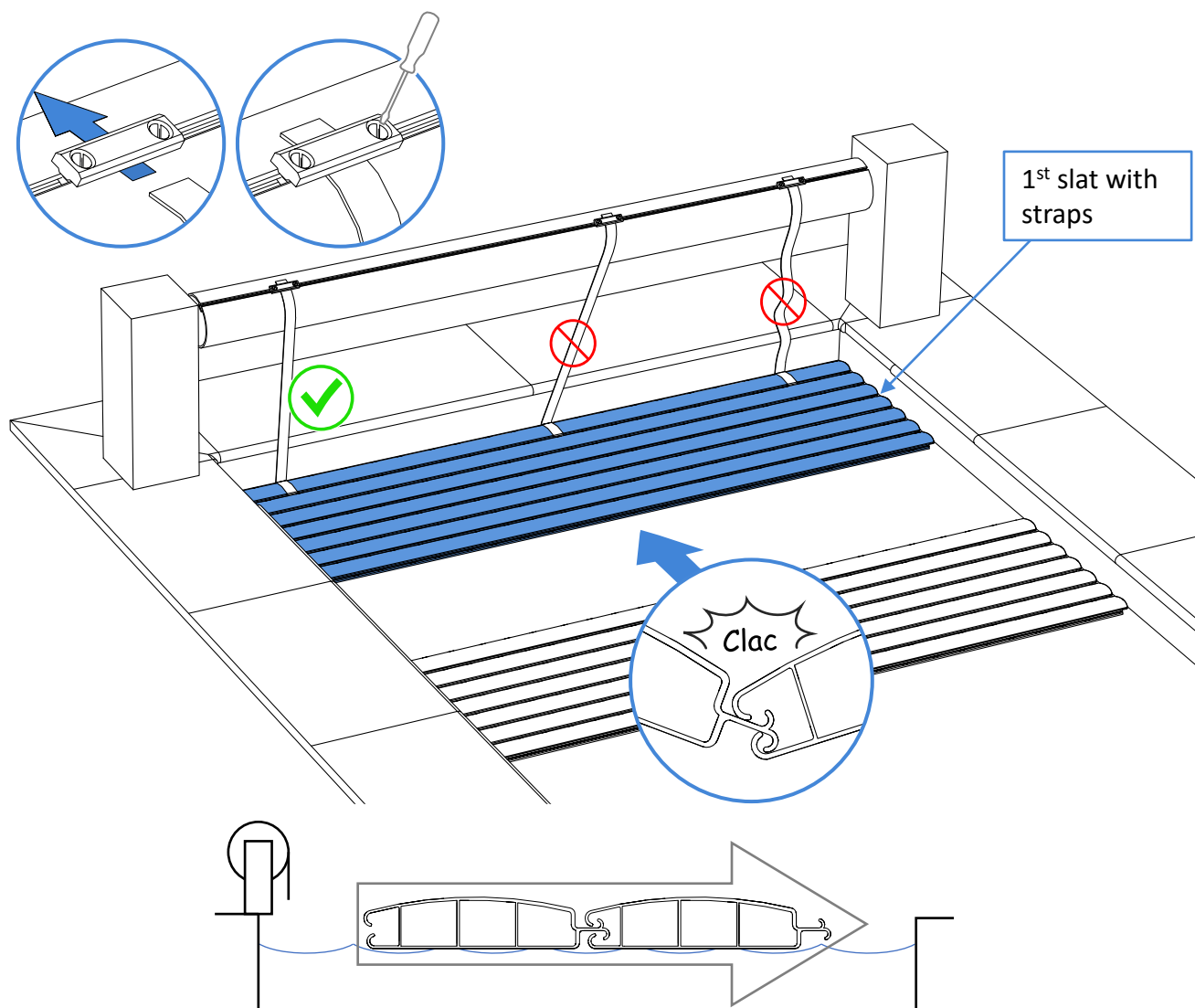

LATERAL SPACES

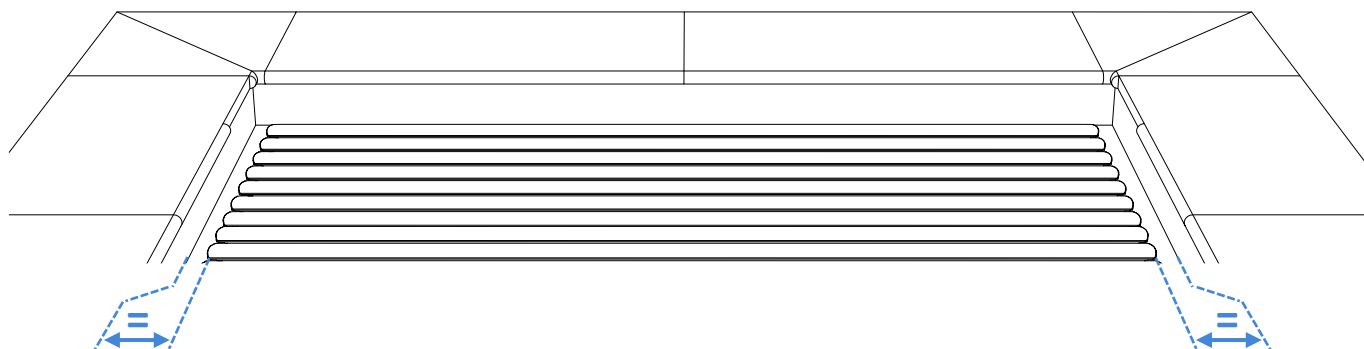

- Check that the slats can move freely through the length of the pool.
- **The total distance must be 7cm or less in order to ensure compliance with NF P 90-308.**
- 10, 20 and 30 mm caps are available for order.

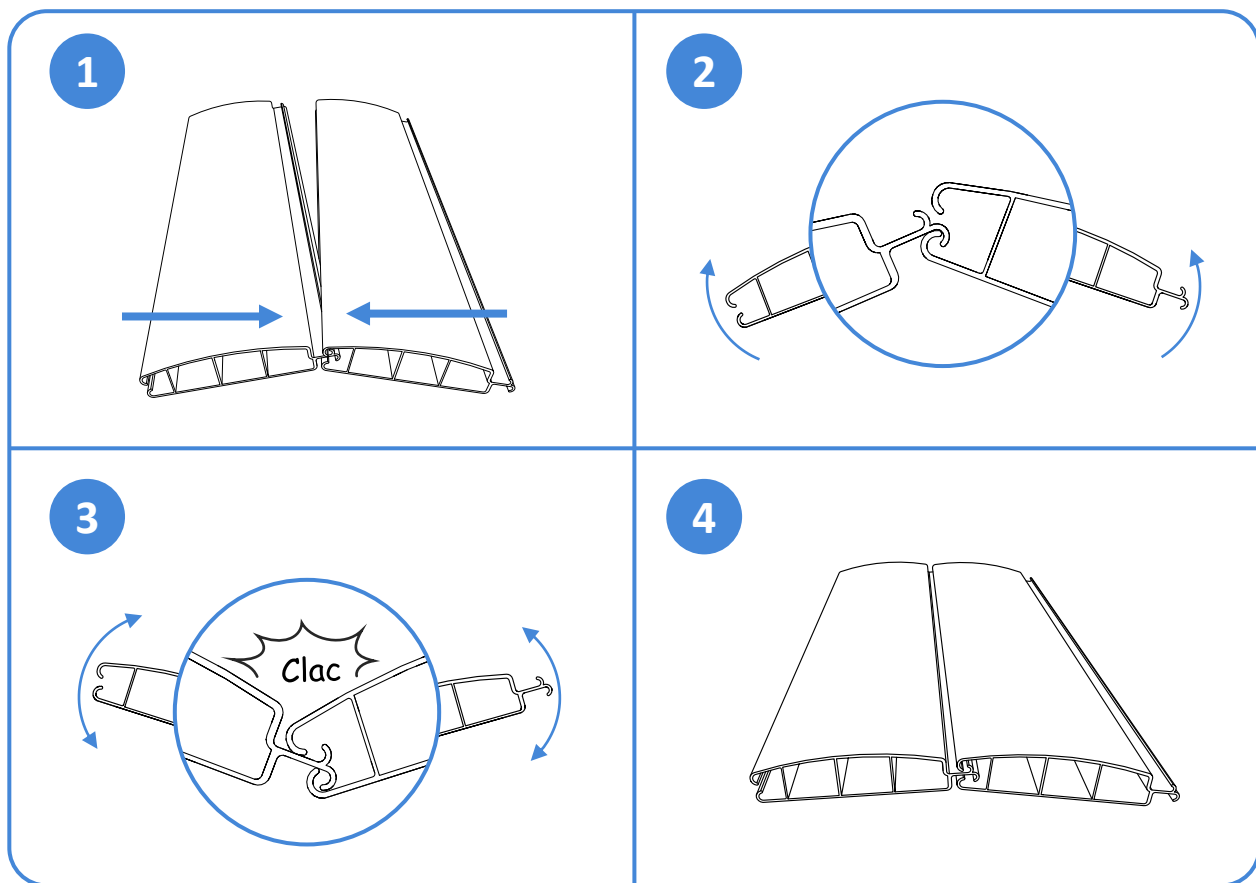

STEPS

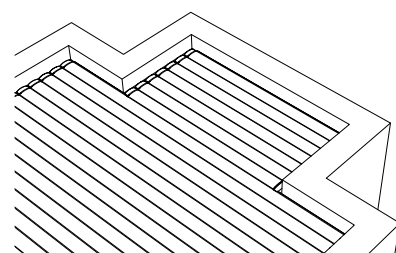
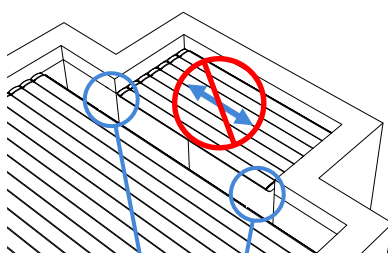
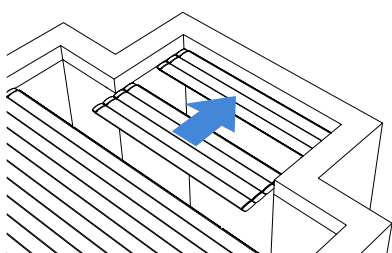
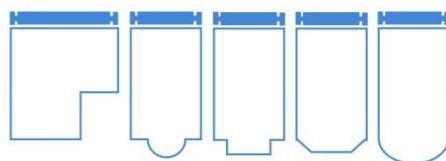

**Do not perforate
the slat**

**Adjust the notch to the width
of the cap.**

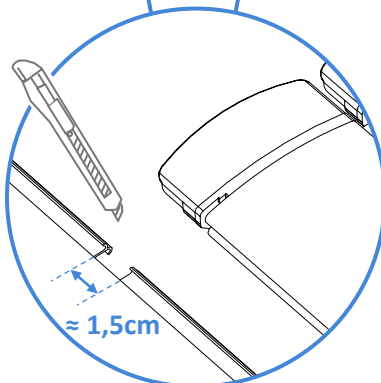

POSITIONING AROUND THE POOL

The safety straps are positioned on the cover in accordance with the instructions stipulated on the purchase order. It is the responsibility of the installer or the retailer to provide accurate measurements of the pool and the position of the skimmers.

There is no need to place clamps on the side of the reel as the dry-mount beach already fulfils the safety function.

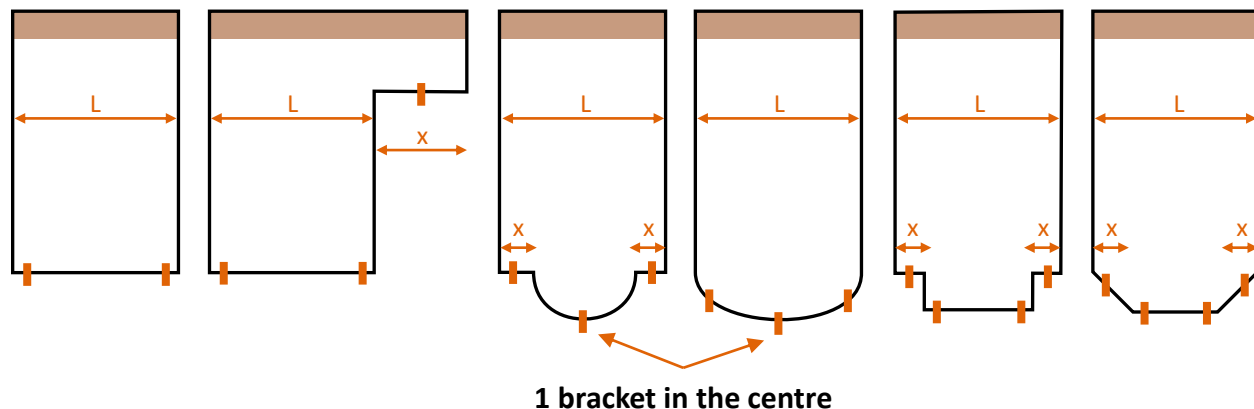

L (m)	≤ 3	≤ 5	≤ 7	> 7
Number of brackets	2	3	4	5

X (m)	≤ 2	> 2
Number of brackets	1	2

Unless otherwise indicated, the safety brackets are mounted at 35cm from the edge of the pool.

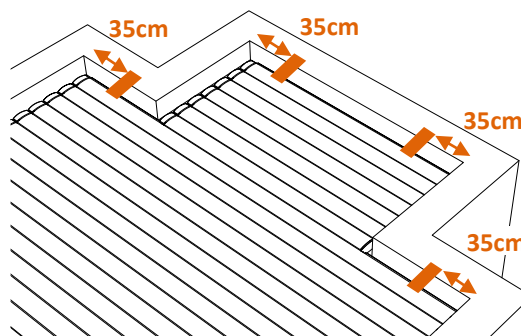

Ensure that the safety brackets match the position of the straps mounted on the cover.

In order to do so, the wall brackets must be fixed whilst the cover is unrolled over the pool and the water level is adjusted to the correct height for skimmers to operate.

Before fixing the brackets, the fastening mechanism should be tested.

The straps should be tight when fastened.



ON WALL

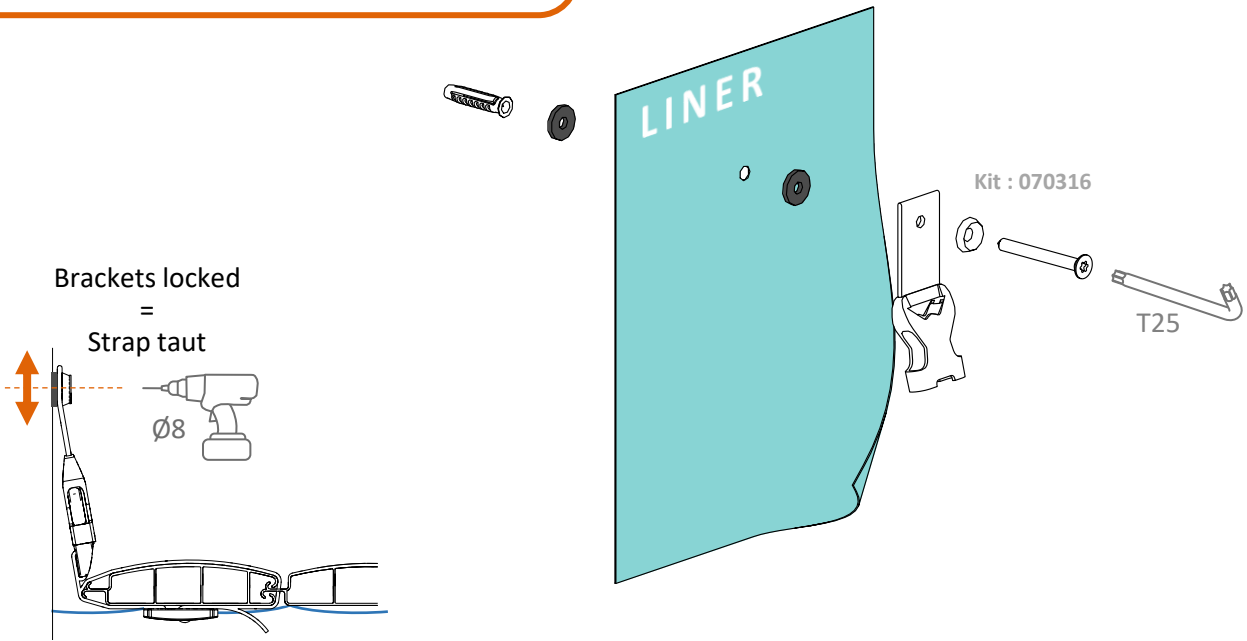

ON FLAT

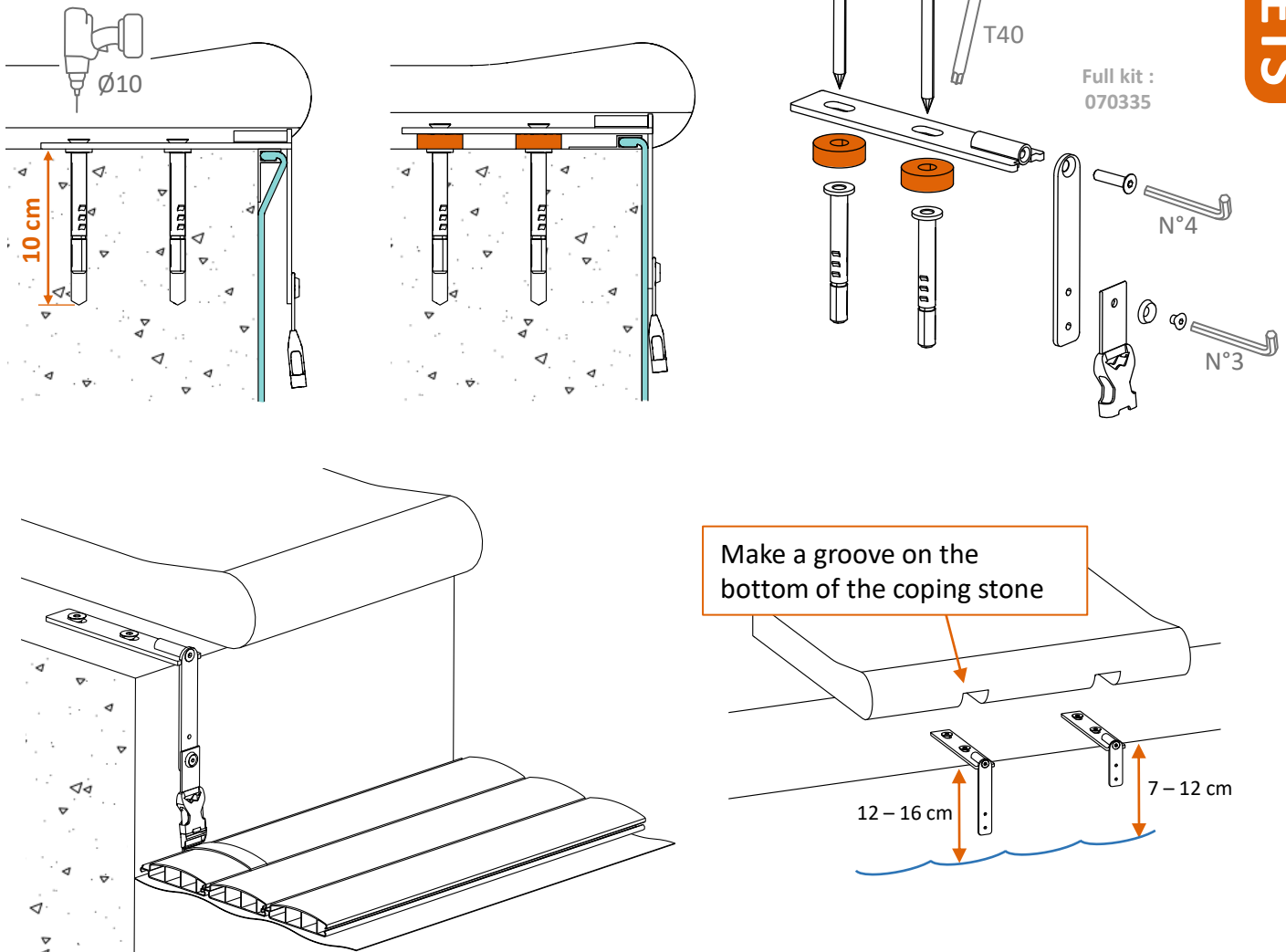

ON WALL

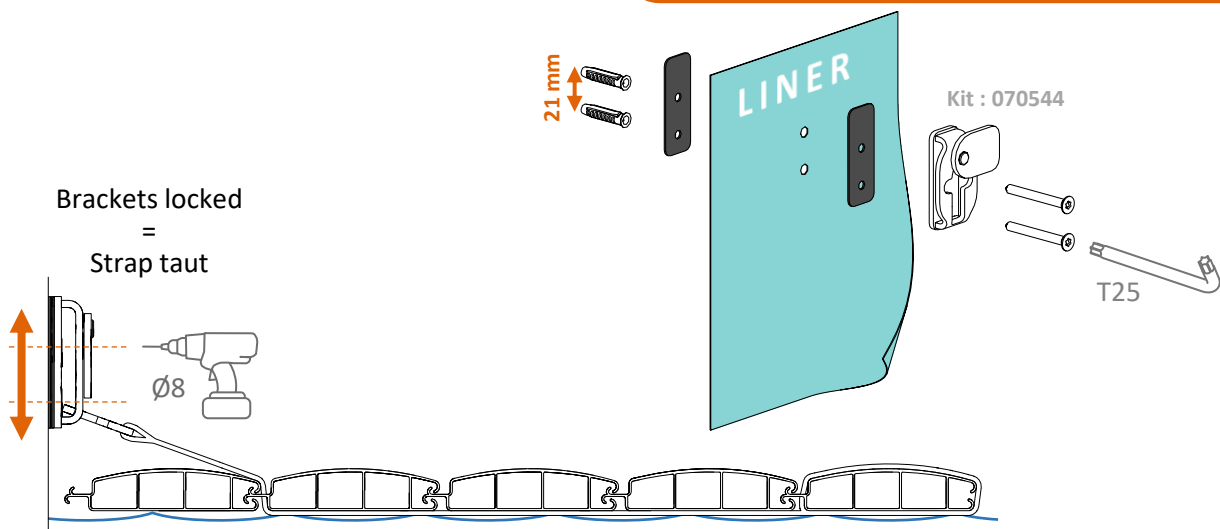

ON FLAT

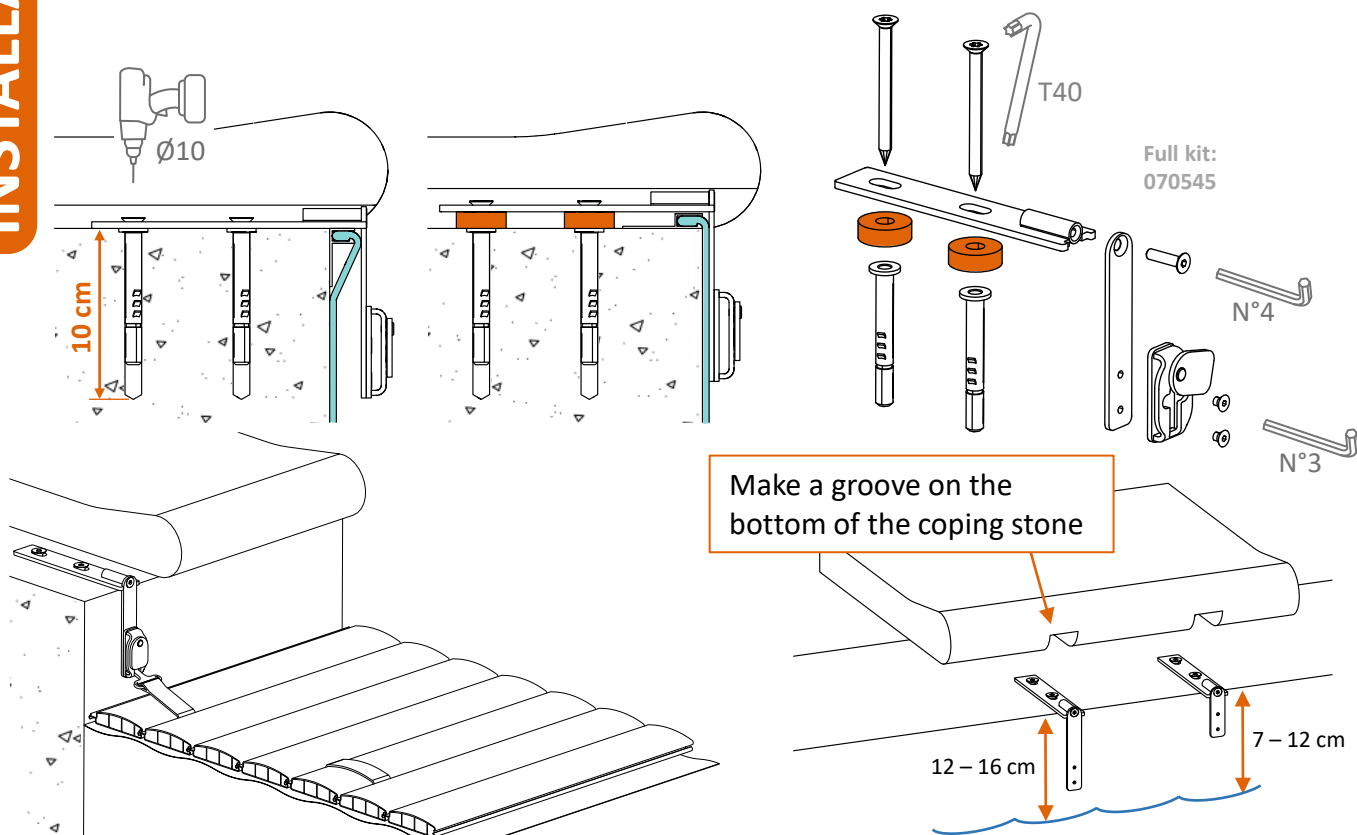

FASTENING

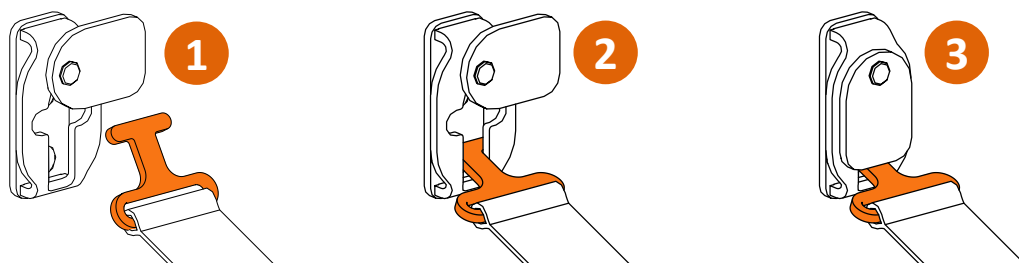

ON WALL

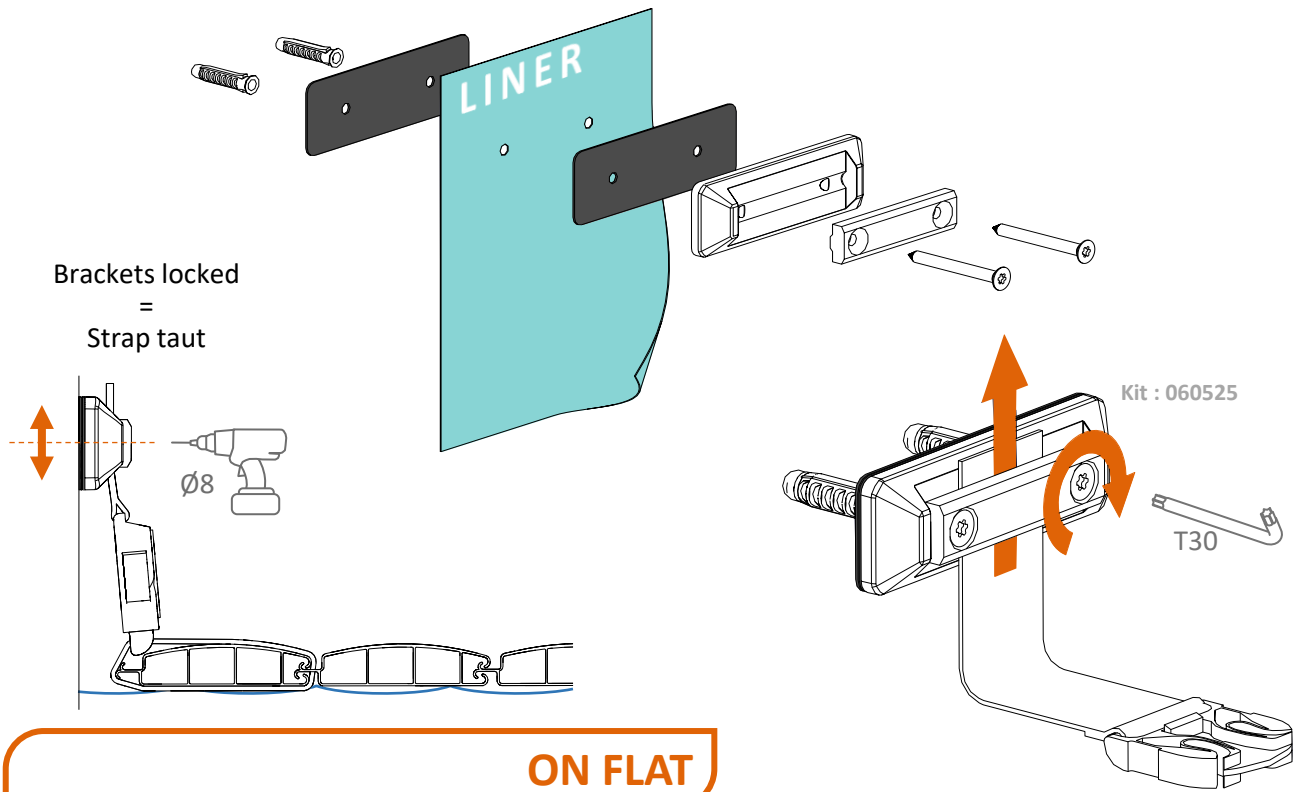

ON FLAT

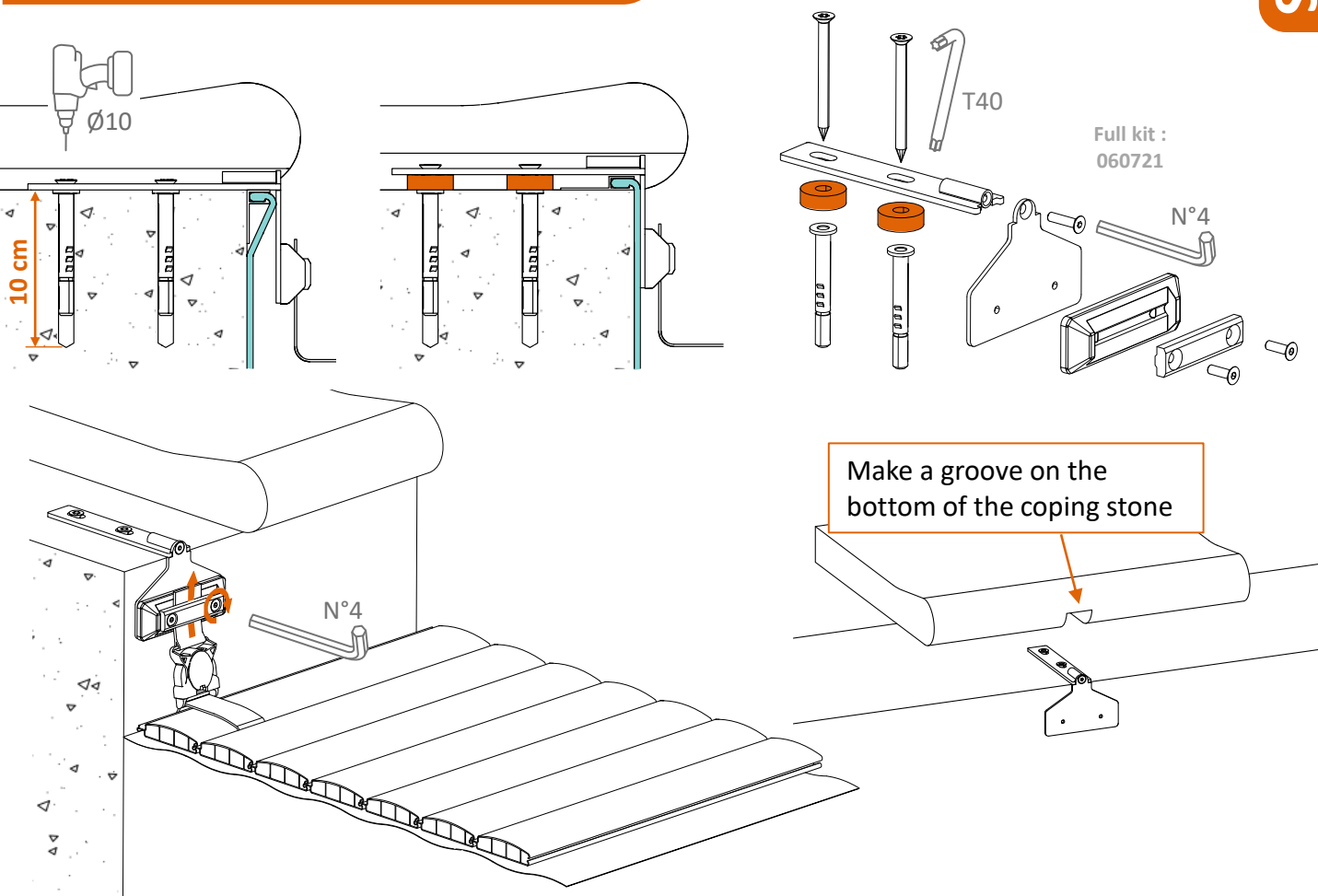

ELECTRIC INSTALLATION

-
- 230VAC
- 230VAC
- 3cm
- 1 2 MOTOR
- S1 S2 S3 S4 SENSORS
- +12VDC
- A(+)B(-) RBYG
- NO COM NC NO CHLORINATOR
- COM NC FILTRATION
- AUX
- CM KEY
- Chlorinator / Filtration / AUX
(see p.26)
- External cables Ø : 9 mm minimum



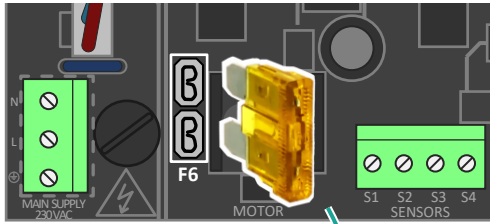

Plug the right fuse (power off)

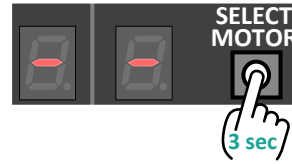
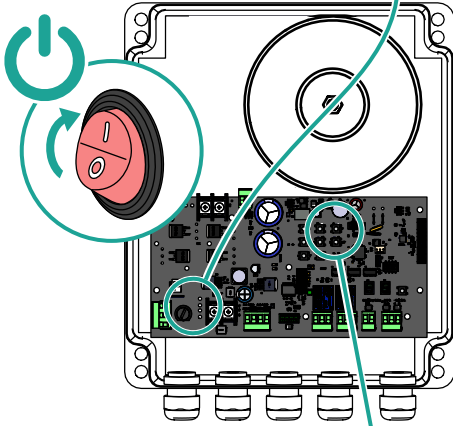

Press for 3 seconds to activate the motor selection and then press briefly to select the motor.

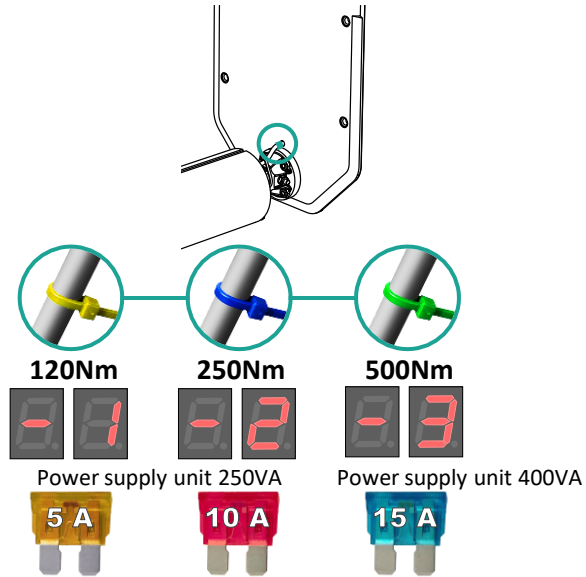

1 Activate MANU mode

2 Fully roll up the cover

3 Activate AUTO mode

4 Skip step 4: soft start specific to submerged gratings

5 Confirm position 1

6 Fully unroll the cover

7 Confirm position 2

SALT CHLORINATOR SERVO-CONTROLLER

- Automatically reduces chlorine production when the cover is closed.
- Servo-controller unit to be connected to the COVER input for the salt chlorinator designed for this purpose.
- **DO NOT CONNECT TO THE CHLORINATOR'S 230 V AC POWER SUPPLY**

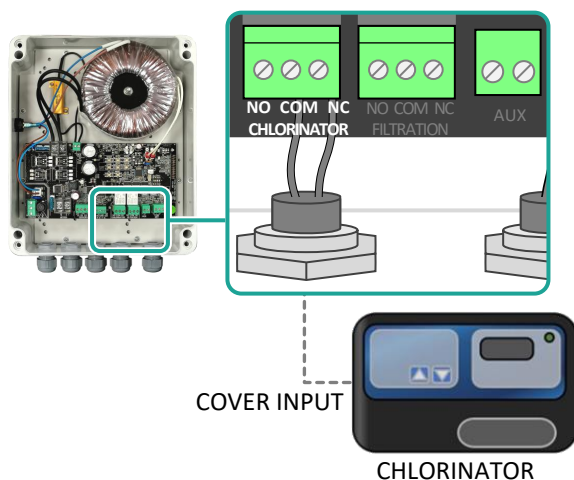
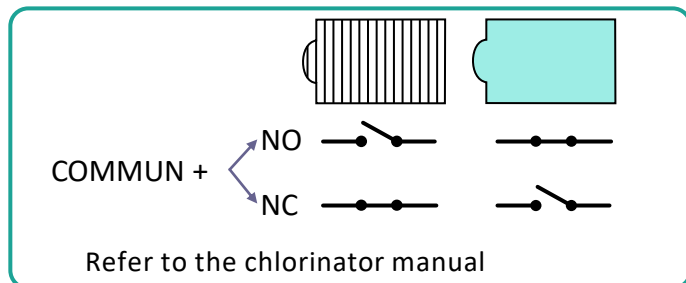

SERVO FILTRATION

- Mainly intended for overflow pools or when the filtration system might interfere with the operation of the cover.
- Allows the filtration to be switched off automatically when operating the cover.
- Servo to be connected to a dry contact of the filtration system.
- **DO NOT CONNECT TO THE 230VAC POWER SUPPLY OF THE ELECTRICAL PANEL OF THE PUMP.**
- Filtration is switched off for 3 minutes when the cover is in operation.

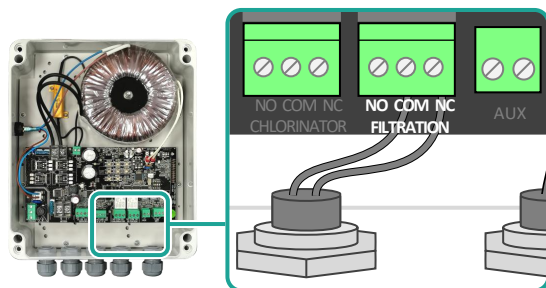
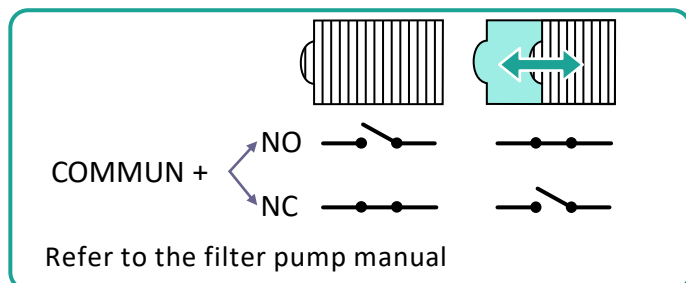

AUXILIARY INPUT

- Option for connecting a water level sensor box or an emergency stop button.
- AUX shunted by default. Keep the shunt if unused.

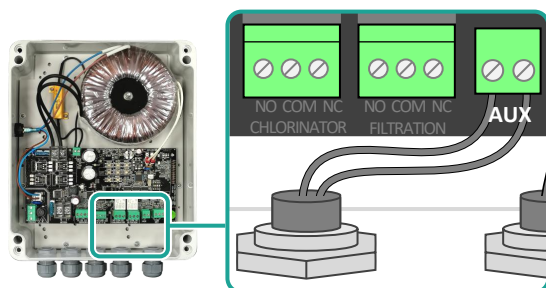
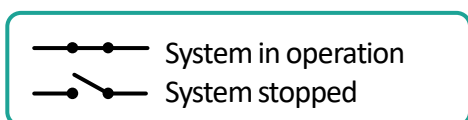

WALL-MOUNTED REMOTE CONTROL

Up to two wall-mounted remote controls can be paired to a receiver

In compliance with standard NF P 90-308:

The distance between a mobile device and the wall-mounted remote control is restricted. Therefore, placing the remote control in the right place is critical to making optimum use of the app, in addition to complying with this safety standard



(see p.28)



KEYRING REMOTE CONTROL

Up to two keychain remote controls can be paired to a receiver



(see p.36)



Bluetooth

Radio frequency

Radio frequency



Radio receiver
Built in to the box.

APPLI



An unlimited number of mobile devices can be paired to a receiver

Range may vary depending on the surroundings and the smartphone or tablet used.

(see p.32)

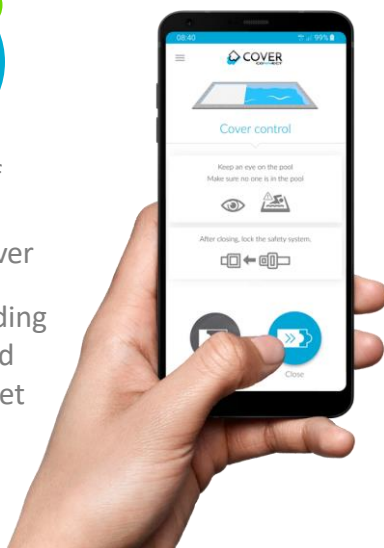

Radiofrequency: frequency 434MHz (deviation = 4KHz) - Max transmitted power = 10dBm
Bluetooth: min frequency 2.4GHz - max frequency: 2.482GHz - Max transmitted power = 0dBm

WALL-MOUNTED REMOTE CONTROL

FLUIDRA declines all liability for any direct or indirect, material or immaterial consequences arising from an incorrect consultation, use and/or interpretation of the information and/or advice contained in this manual by the user or in cases of force majeure.



FASTENING

To comply with NF P 90-308:

- the remote control must be in constant contact during the closing operation
- the remote control must be installed in a fixed position from which it is possible to check that no one enters the pool during the operation.
- Fit the remote control at a height of below 2 m.

PAIRING

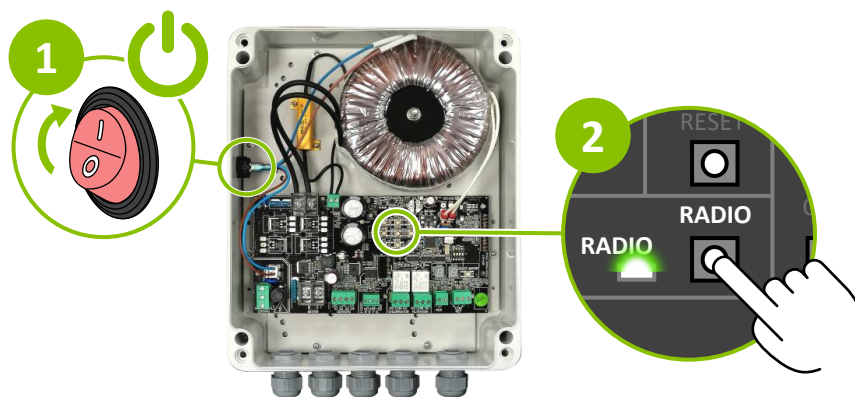

Radio receiver
Built in to the
universal box.

Long press on RADIO
until it flashes
Pairing in progress

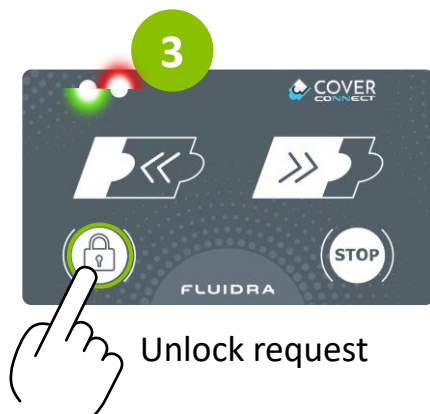

Unlock request



Default unlock code

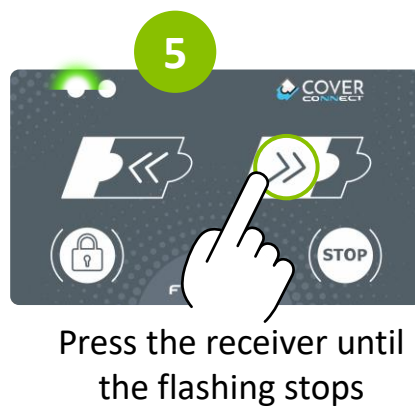

Press the receiver until
the flashing stops
Pairing complete

USE

UNLOCK

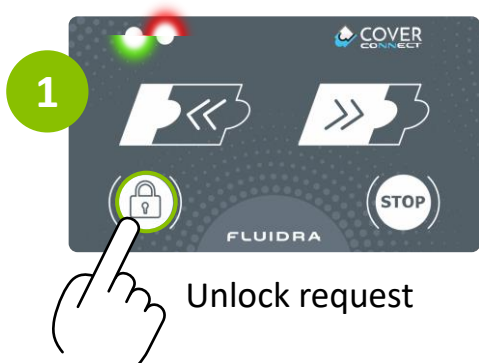

In case of error, wait 10 seconds or press 4 keys to return to step 1.

OPEN/CLOSE

After unlocking:

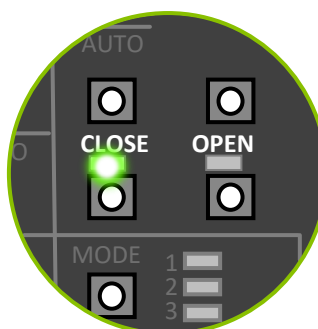
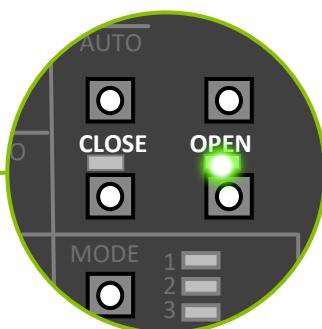
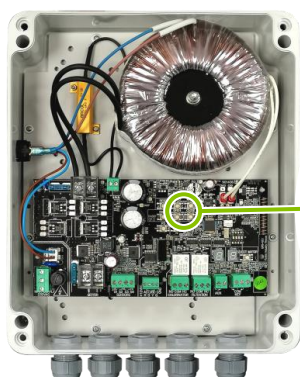
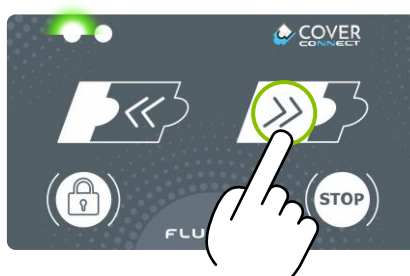

Check receiver

LOCK

Short press or automatic lock after 10 seconds of inactivity.
Long beep when locked.

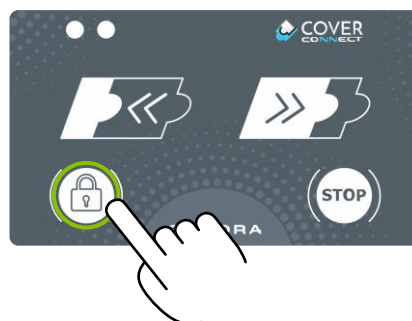

Make sure the remote control is locked when you leave the pool area.

CHANGE MODE

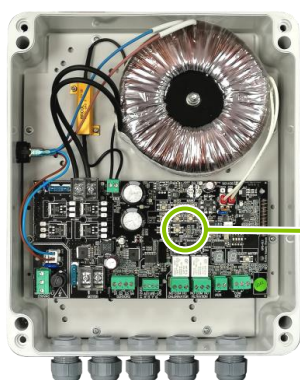

The on LED indicates the current mode
(mode 1 by default)

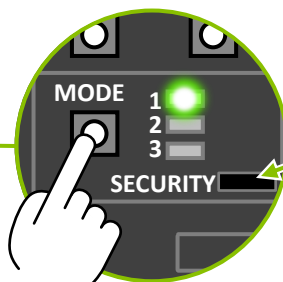

Press to change mode

Remove the safety
device to access mode 3



**Mode 3 not compliant
with NF P 90-308**

MODE 1: KEEP OPEN/CLOSED



Press and **hold**:
open cover



Press and **hold**:
close cover

MODE 2: KEEP CLOSED

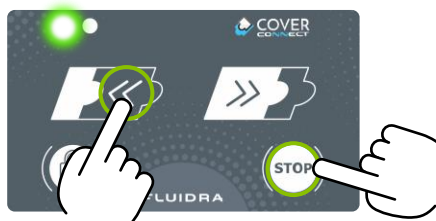

Short press:
open cover

Short press:
stop cover

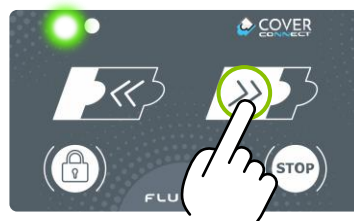

Press and **hold**:
close cover



**NOT COMPLIANT
WITH NF P 90-308**

MODE 3: IMPULSE



Short press:
open cover

Short press:
stop cover

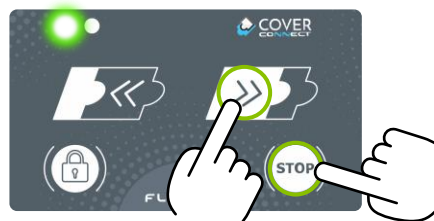

Short press:
close cover

Short press:
stop cover

CHANGE LOCK CODE

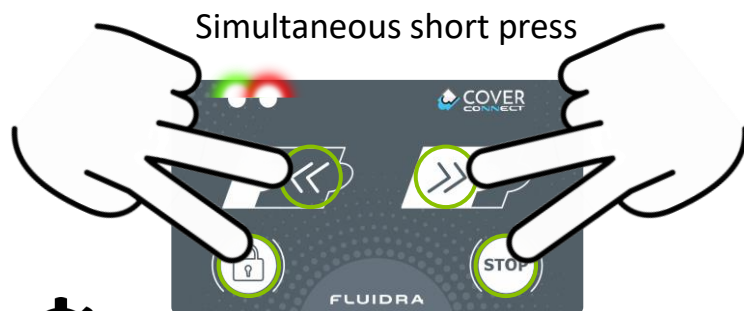

- 30 seconds to enter the new code.
- The code must be a combination of 4 keys.
- After 30 seconds, the LEDs stop flashing, the keypad locks and if no new code is entered, the old code is maintained.
- If you forget the code, you always have the option of creating a new one.

Continuous for 2 seconds if:
code valid code invalid

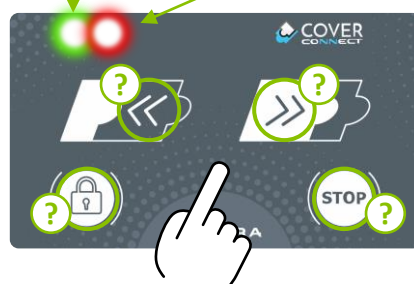

BATTERY LEVEL

Green LED flashing during opening/closing: Battery OK.



Red LED flashing during opening/closing: Battery level low, needs changing.

CHANGING THE BATTERY



•If the base is reconnected the wrong way round, a red LED will flash on the inside and outside of the remote control.

2 Be careful with the keypad base when opening the box and changing the battery.

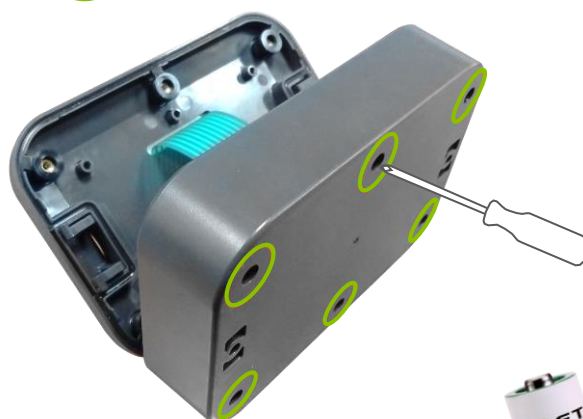

The remote control must be connected to a 3.6V DC power supply in the form of a SAFT-make lithium battery, model LS14500.

Fluidra code: 907676

Non-rechargeable.

Do not use a 1.5V alkaline battery.

In winter, remove the battery and store the wall-mounted remote control out of the cold.





- Cover Connect is an application for remote automatic cover operation using a mobile device (smartphone or tablet running on Android or iOS) with the latest updates.



- Use the application from a position where you have a full and unobstructed view of the pool and make sure no one gets into the pool when the cover is being opened or closed. A distance limitation is applied between the terminal and the wall-mounted remote control.
- For best application performance, the mobile device must be pointing at the wall-mounted remote control while the cover is being opened or closed. Performance may vary depending on the mobile device used as each one has its own technical specifications and performance options.
- The cost of all the software and hardware required to download and use the application, together with all other related costs, including telecommunications and subscriber costs, are exclusively on the user's account.
- If the cover is not working or if there is a power cut or similar and you cannot close the cover or make the pool safe, take the necessary measures to prevent anyone getting into the pool, especially children, until the system returns to normal operation.
- The user must also fit the cover with a wired key control system to operate the cover if the paired terminal is unavailable.
- FLUIDRA would like to point out that technology, the services available and applicable legislation are constantly changing. Therefore, the user is hereby informed that FLUIDRA may modify the content and features of the application and services in accordance with technical and/or legislative developments.
- The user hereby agrees to consult the App Store® and Google Play® platforms regularly to check the availability of new application updates and download them before continuing to use the services.
- FLUIDRA declines all liability for any direct or indirect, material or immaterial consequences arising from an incorrect consultation, use and/or interpretation of the information and/or advice contained in the application by the user or in cases of force majeure. Please refer to the general terms and conditions of use of the application.

- Enable Bluetooth on your mobile device, switch the app on and follow the instructions.
- Read and accept the general terms and conditions of use.
- Pairing:
 - Press "connect".
 - Press the "start" or "stop" button on the wall-mounted remote control.
 - Set a 4-digit password.

USE

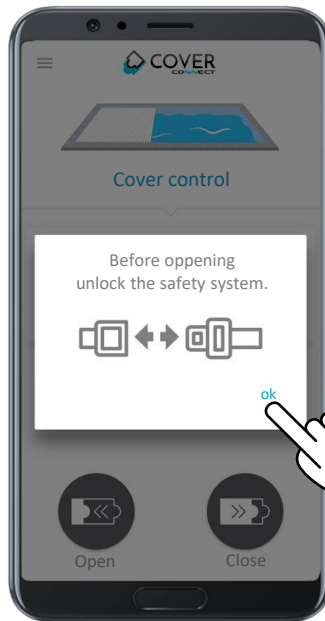
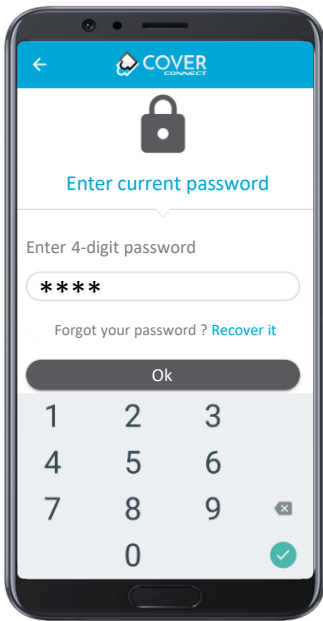

Unfasten the safety clamps.
Press OK.

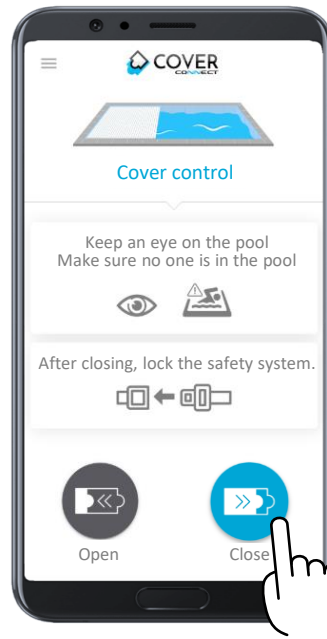
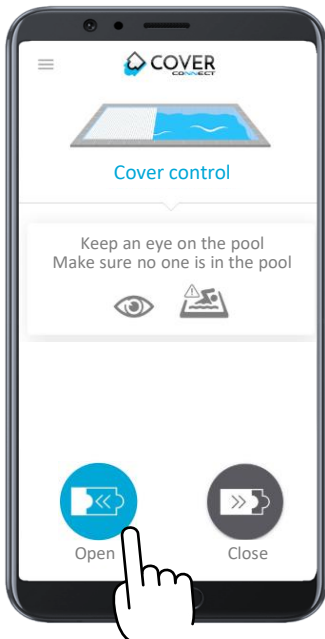

Press and hold: pool opens/closes

The application operating mode depends on the receiver mode (long/short press).
([see p.30](#)).

Switching the app off stops the impulse response function.
(Receiver in mode 2 or 3).

Remember to lock the safety clamps in position once the cover has been closed.

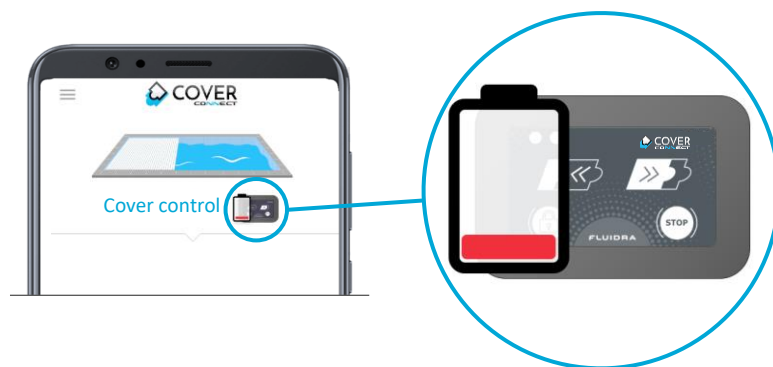

If this pictogram appears, change the battery in the remote control.
(See p.31).

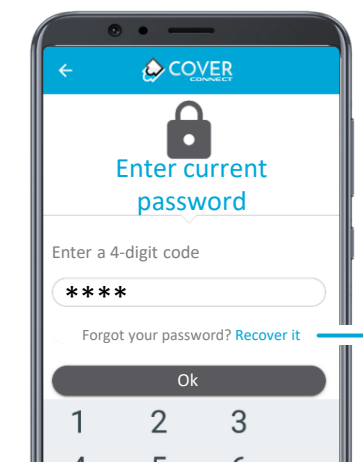

PASSWORD RECOVERY

Factory password.
Please check user manual.

1 1 1 1

Cancel

Ok

CONTEXTUAL MENU

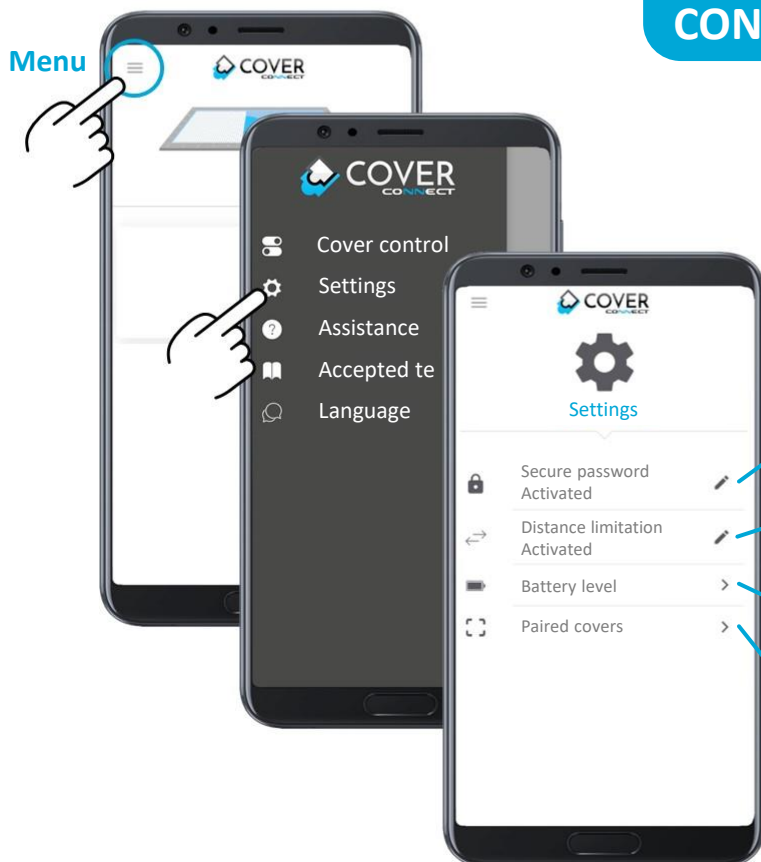

Enable/disable/change the password

Enable/disable restriction on distance

Set the wall-mounted remote control's battery level (optional)

Re-pair the mobile terminal

COMPLIANT WITH THE NF P90-308 STANDARD IF:

- Security code enabled
- Distance limitation enabled
- The user has a full and unobstructed view of the pool all the time the cover is being opened or closed.
- The application operating area is entirely within the 5-metre limit around the pool.

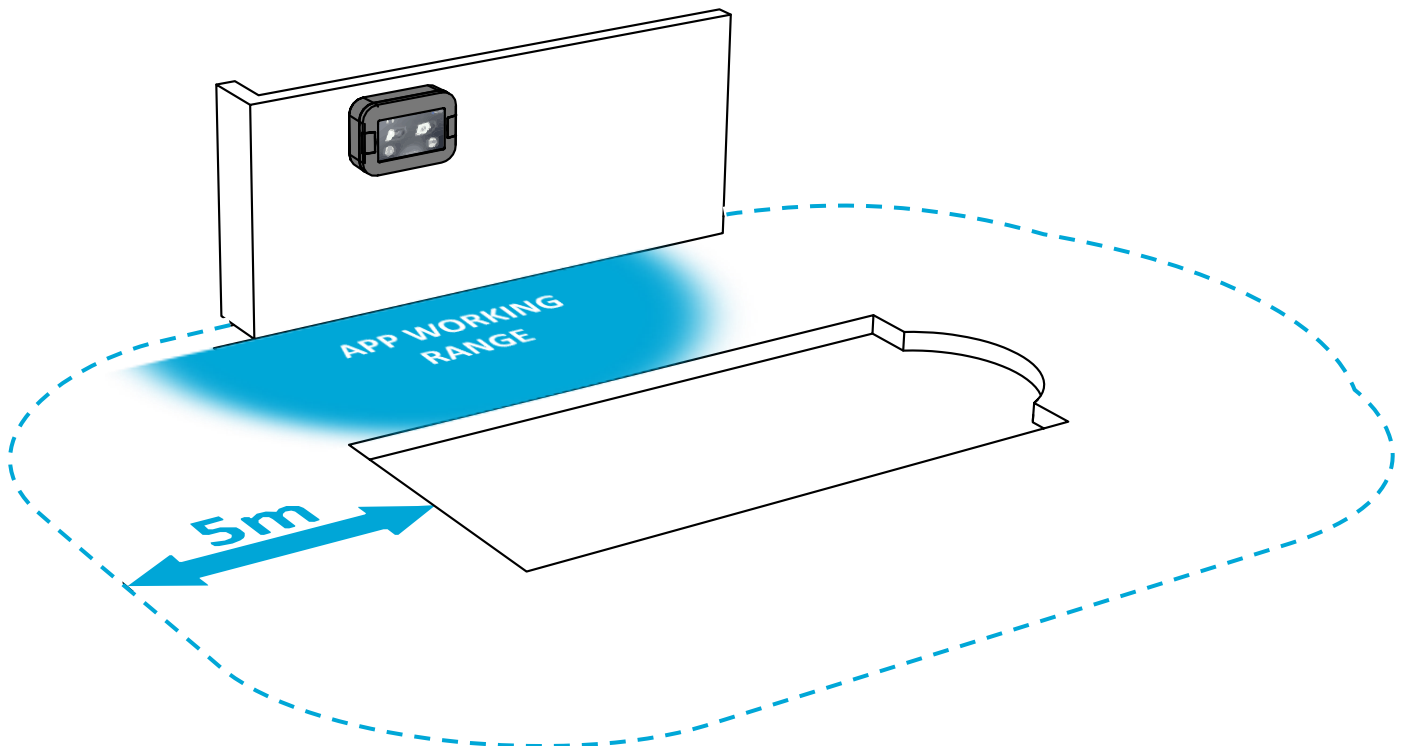
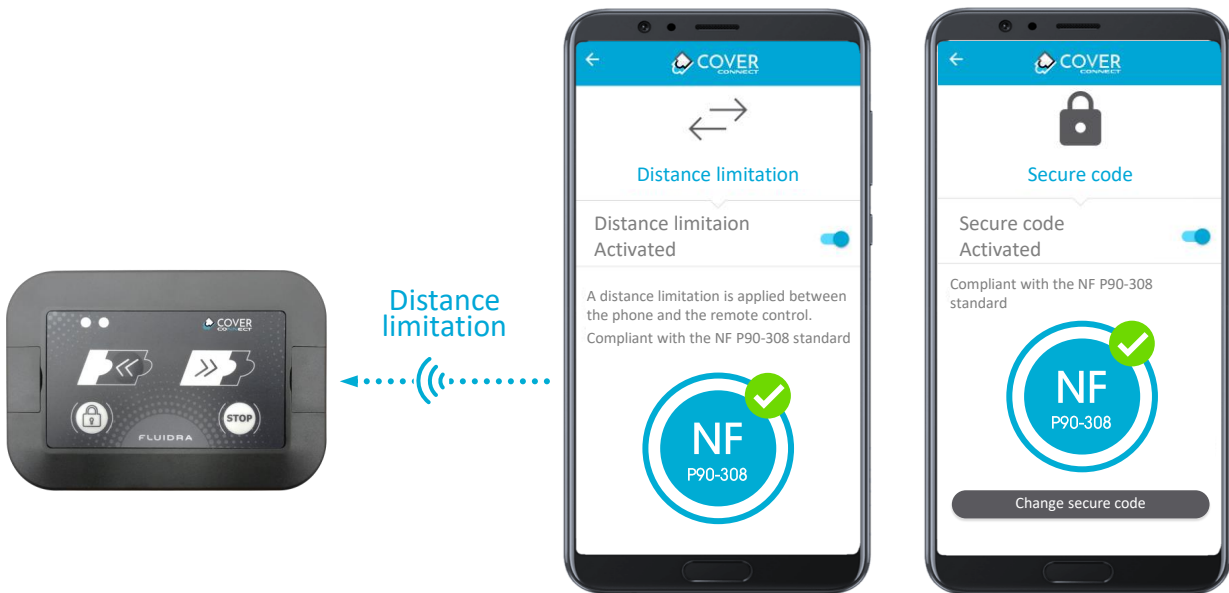



FLUIDRA declines all liability for any direct or indirect, material or immaterial consequences arising from an incorrect consultation, use and/or interpretation of the information and/or advice contained in this manual by the user or in cases of force majeure.

Use the remote control while standing in such a position as to have a full and unobstructed view of the pool at all times and ensure that no one enters the pool when operating the cover.

The range of the remote control key fob may vary depending on the surroundings.

PAIRING

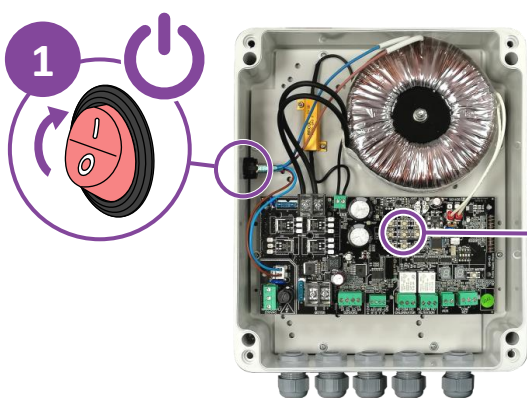

Radio receiver
Built in to the box.

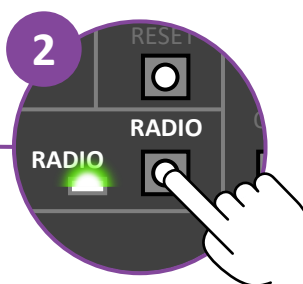

Long press on RADIO
until it flashes
Pairing in progress



Press the receiver until
the flashing stops
Pairing complete

CHANGING THE BATTERY



3V flat lithium battery
Reference CR 2032





CHANGE MODE

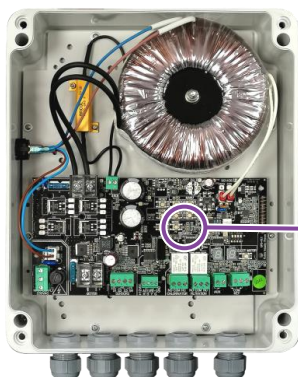

The on LED indicates the current mode
(mode 1 by default)

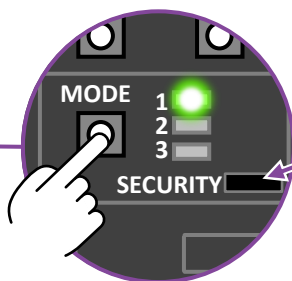

Short press:
change mode

Remove the safety
device to access mode 3



For safety reasons, mode 3 is
not recommended.

MODE 1: KEEP OPEN/CLOSED

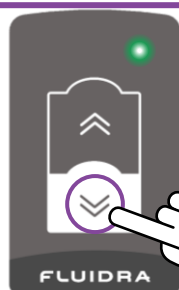

Press and **hold**:
open cover.

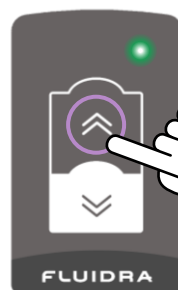

Press and **hold**:
close cover

MODE 2: KEEP CLOSED



Short press:
stop cover

Short press:
open cover

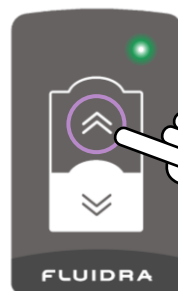

Press and **hold**:
close cover

MODE 3: IMPULSE



Short press:
stop cover

Short press:
open cover



Short press:
stop cover

Short press:
close cover.

- The person opening or closing the pool must keep a careful eye on the procedure throughout and ensure there is nobody in the pool.
- It is essential to open or close the cover fully. Never leave it half-open.
- Always check that the water level in the pool is constant and suitable for the skimmers in order to prevent the slats from rubbing, becoming blocked or permanently damaged. A water level regulator is strongly recommended.
- The pool cover must only be opened and closed by a responsible adult.
- The security straps must be fastened when the cover is closed.
- The control device must be locked (by removing the key or locking the remote control) when the cover is not being opened or closed.
- Unfasten the straps before opening the cover to avoid damaging the cover or the mechanism.
- Check there are no objects floating in the pool before operating the automatic cover.
- If there is any cleaning equipment in the pool, ensure that the hose or supply cable does not interfere with operation.
- Ensure that no-one:
 - blocks the cover during opening and closing
 - holds onto or pulls the cover
 - lies, walks or jumps on the cover
- The cover may need to be adjusted by hand during opening or closing in special cases (e.g.: strong side-winds, with overflow pools or special configurations).
- Limit operation of the cover when the temperature is below 5°C and do not operate the cover at all below 0°C or when it is frozen to the water.
- If the cover is installed in an indoor pool or under cover, ensure that the maximum air temperature does not exceed 40°C. Ensure that the area is well ventilated in order to prevent any damage to the cover and the mechanical parts.
- If there is a risk of hail, roll up the cover. It is highly advisable to take out insurance against the risk of hail damage.

Care of the automatic cover is the responsibility of the user.

COVER AND ACCESSORIES

- Check the slats regularly to ensure that they are correctly interlocked .
- Check the state of the brackets and safety straps every time the cover is used.
- Check the straps fastened to the roller: they should always be correctly connected and all should have the same level of tension.
- Check the ends of the slats. Ensure that the slats, stoppers and caps are all correctly aligned. Slats not aligned with the rest of the cover may become blocked during opening and closing and lead to significant damage.

WATER PROPERTIES

- In order to prevent over-chlorination or pH imbalance it is advisable to install an automatic water treatment device. This is essential for indoor pools.
- When using electrochemical devices which cause metal corrosion (for salt water chlorination, copper-silver electrolysis, etc.), ensure that steps are taken to reduce harmful effects: earth the pool and the equipment in order to reduce the risk of stray currents.
- As a rule of thumb, the need to produce an oxidising agent is reduced by between 50% and 90% when the pool is covered. Ensure the device is working correctly whenever the pool is closed for long periods of time.
- In order to ventilate the water during the swimming season it is necessary to open the automatic cover at least twice a day and engage the water treatment device in the power supply unit using the electrolyser contact provided.
- If over-chlorinated, ventilate the water by opening the cover. Ensure that nobody enters the water while the pool is open.
- In order to prevent warping, ensure that the slats are not exposed to a difference in temperature greater than 15°C between the outside air and the water (e.g.: very warm pool in a cold environment).
- During chlorination shock treatment, roll up the cover in order to avoid damage to slats and ensure that there is no access to the pool.

- It is essential for the pH level of the water to be correct to avoid damage to the cover and its mechanism:

Parameter	Threshold values	To increase	To decrease	Frequency to be checked
Salt level	2.5~4 g/L (kg/m ³)	Add salt and filter constantly for 24h, chlorinator off.	Partially empty the swimming pool and fill it with tap water	every three months
pH	7 - 7,5	add pH+	add pH-	Weekly
Free chlorine (DPD1)	0,5 – 3 ppm	Increase the production of chlorine or carry out chlorination shock treatment and leave the filter system on for 24 hours with the cover rolled up.	reduce the production of chlorine and roll up the cover.	Weekly
TAC (alkalinity)	80 - 120 ppm	Add alkalinity corrector, TAC+	Add sulphuric acid	every three months
TH (hardness)	180 - 250 ppm	Add calcium chloride	Add scale sequestering agent	every three months
Stabiliser (cyanuric acid)	< 30 ppm (g/m ³)	Add cyanuric acid only if necessary (heavy exposure to UV or intensive use)	Partially empty the swimming pool and fill it with tap water Replenish a part of the water in the swimming pool	every three months
Metals (Cu, Fe, Mn...)	0 ppm	Add scale sequestering agent DO NOT use natural water sources. Use mainly water from the city water system.		Annually

- Too much or repetitive use of water treatment products over a long period may cause permanent damage to the automatic cover, both to the mechanical parts and to the slats.
- Lack of water treatment products may cause algae to appear and cause permanent brownish stains on the slats caused by the rotting process.

CLEANING OF COVER

- Frequency of cleaning: every two months (depending on pool surroundings, atmospheric pollution, and the presence of limescale in the water).
- Clean the cover with a pressure cleaner, if necessary with a descaling or degreasing product.
- Never use an abrasive sponge on the slats or any other abrasive product.
- Never use an aggressive solvent for PVC or polycarbonate.
- Descal the joints between the slats regularly. Excess limescale can reduce mobility between the slats and impair the rolling process. Check the hardness of the water according to our recommendations.
- Ensure that there is no build-up of leaves or other vegetation on the cover or between slats. This may rot and cause black or brownish stains.



- It is the responsibility of the installer/retailer to recommend the best way of leaving the pool over winter. This will depend on the availability of the user and the geographical location of the pool.

WARNING: Never operate the cover if caught in ice or covered with snow.

- Clean the pool thoroughly before leaving for winter.
- Clean the cover with a high pressure cleaner.
- Check the water level.
- Close the cover and fasten the safety straps.
- Lock the control device (remove the key or lock the remote).

PASSIVE WINTERING

- Treat the water with wintering products (never use wintering products containing copper).
- Ensure there is enough water to make it possible to fasten the safety straps.
- Block skimmer pipes, suction points and backflows.
- Bleed pipes in the machine room.
- Protect your skimmers and any piping exposed to icing with covers.
- Place winter buoys under the cover.
- Switch off the electricity in the automatic cover power supply unit in order to ensure that the cover cannot be operated when iced up or covered with snow.

ACTIVE WINTERING

- If the filtration system continues to be used over winter, check the water properties of the pool on a regular basis.
- Take all necessary steps to prevent over-chlorination of the water which may cause permanent damage to the automatic cover.

WINTER ACCESSORY AVAILABLE FOR SALE

- A winter net can be installed over the cover. This is strongly recommended if the pool is surrounded by trees in order to prevent rotting leaves or other vegetation falling on to the slats causing permanent staining.

- In case of malfunction or repair making it impossible to close and secure the pool, take all the necessary steps to prevent access to the pool until the cover has been repaired.

SPARE PARTS

- All spare parts must be original for our guarantee to be valid and for the cover to comply with existing regulations.
- Go to the Pro area at <https://client.fluidrasurmesure.fr>
- Technical documentation section.
- Contact your dealer/distributor.
- Replacement of slats:
 - Slats can only be replaced by original Fluidra slats.
 - The colour of slats replaced may not be exactly the same as those replaced.
- Replacement of motor and power supply unit:
 - Replacement motors and power supply units must be Fluidra products and must be replaced by a qualified technician.



ANNUAL SERVICE

- Before resuming use, a complete service is necessary to detect any damage which might interfere with the functioning of the cover and the roller.
- Check the state of the slats, ensuring there are no cracks, and ensure that straps can be properly attached.
- If there are any cracks or breaks in the slats, contact your installer/retailer to request replacements.
- Check the state of the security straps, clips and brackets for signs of ageing.
- The brackets and the straps must be replaced every 3 years or in the event of breakages.
- Check that the electric equipment is working properly and connections are tightened. Ensure that there is neither damp nor rust on any of the electric contacts (terminals on power supply unit, connection box, key switches, etc.).
- Check that the controls are working correctly. Switching the key to off or use of the remote should cause rolling or unrolling operation to stop immediately.
- Check that the nuts and all the screws on the roller are well tightened.
- Check that the straps are correctly fastened to the roller
- Check that the filter system, the overflow, and the water level regulator are working correctly.
- Unroll and roll up the cover several times in order to check that it is in good working order and to check the limit-switches.

- The guarantee covering a faulty product is only valid after the faults have been confirmed on our premises or in situ by the installer/retailer on the basis of information from the FLUIDRA technical service.
- Expenses arising from removal, re-installation and transport are not included in the guarantee (provision of water, chemical products, damages, interest, as well as any penalization demands).
- The guarantee does not cover any damage due to transport. The customer must note any objection or refuse to accept any damaged packages. In order to continue improving our services, however, FLUIDRA INDUSTRY FRANCE does invite its customers to report any issues connected to transport of goods.
- All guarantees are void in the event of inappropriate use (e.g. operation of cover while safety straps still fastened), negligence, or lack of care by purchaser or any other sub-purchaser. Faults or damage to products caused by external accident, to abnormal conditions of storage and/or safekeeping on the purchaser or sub-purchaser's premises are not covered by the FLUIDRA INDUSTRY FRANCE guarantee.
- The guarantee is not valid in the event of malfunctions or damage connected to incidents out of FLUIDRA INDUSTRY FRANCE's control, such as poor power supply, poor connections, failure to respect water quality parameters, or water levels. The guarantee is also void in the event of problems arising from a third party's repair of or interference with the products, from a purchaser's poor understanding of requirements, and from any modifications made to the products.
- Assembly and installation of the products is the exclusive responsibility of the purchaser, who is committed to respecting the instructions for assembly and use provided with the products. Therefore any faults resulting from assembly and/or installation of the product and any failure to respect the instructions for assembly and use renders the guarantee void.
- This guarantee neither covers brownish staining, discolouration, nor warping of the slats. Hail or storm damage and any defect caused by inappropriate use of the cover also renders the guarantee void. Also excluded from this guarantee are corrosion and degradation of materials caused by salt water chlorination devices or any device producing an electrochemical or electro-physical reaction, which generally accelerates metal corrosion.
- Damage caused by lightning, the unauthorised immersion of geared motors, the inappropriate use of equipment or any damaged or degraded equipment is not covered by the guarantee.
- For guarantee periods, please refer to FLUIDRA INDUSTRY FRANCE general sales conditions.

MOBILE APPLICATION

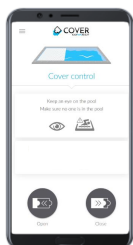

If the app does not work.

Troubleshooting:

- ☐ Update the app
- ☐ Bring the mobile terminal closer to the wall remote control
- ☐ Check that the wall remote control is working
- ☐ Re-pair the mobile terminal ([see p.34](#))
- ☐ Update the mobile terminal operating system
- ☐ Try with other mobile terminals (smartphone/tablet)

If the problem persists, contact your dealer.

WALL-MOUNTED REMOTE CONTROL



If the wall remote control does not work.

Troubleshooting:

- ☐ Check the battery and replace it if necessary ([see p.31](#))
- ☐ Check that the control unit in the electrical panel is working ([see p.45](#))
- ☐ Re-pair the wall remote control ([see p.28](#))

If the problem persists, contact your dealer.

KEYRING REMOTE CONTROL



If the keyring remote control does not work.

Troubleshooting:

- ☐ Check the battery and replace it if necessary ([see p.36](#))
- ☐ Move the keyring remote control closer to the electrical panel
- ☐ Check that the control unit in the electrical panel is working ([see p.45](#))
- ☐ Re-pair the keyring remote control ([see p.36](#))

If the problem persists, contact your dealer.

- If no control device is working, test the control in the electrical panel.

If the control unit on the electrical panel does not work

Troubleshooting :

If the display is on:

- ☐ Check that no alarms have been triggered ([see p.46](#))
- ☐ Check the 24VDC protection fuse
- ☐ Check the wiring
- ☐ Check that nothing is blocking the cover
- ☐ Check that the electrical panel has 24VDC (OPEN or CLOSE maintained)

If the display is off:

- ☐ Check that the electrical panel is switched on
- ☐ Check the wiring of the electrical panel power supply
- ☐ Check the 230VAC protection fuse
- ☐ Check the power supply upstream of the electrical panel

If the problem persists, contact your dealer.

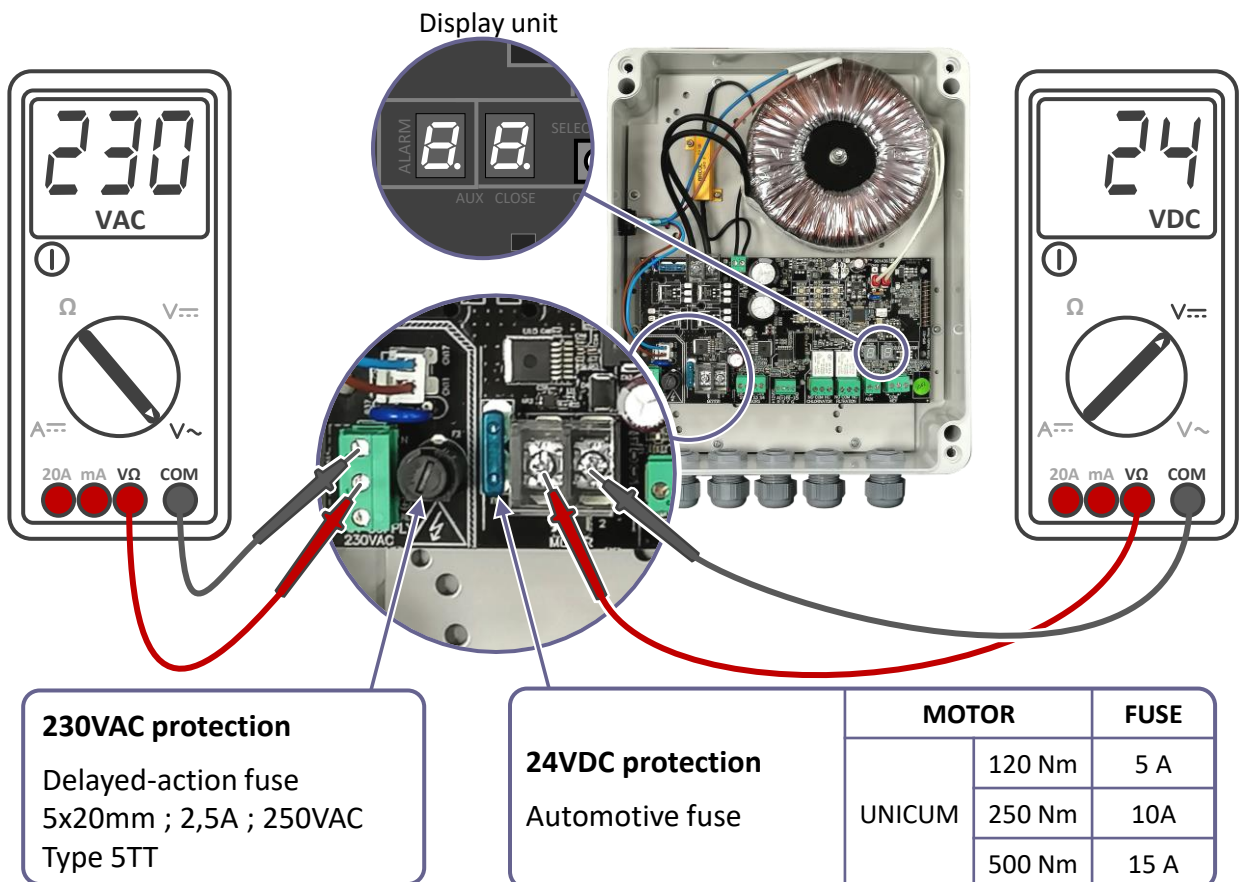
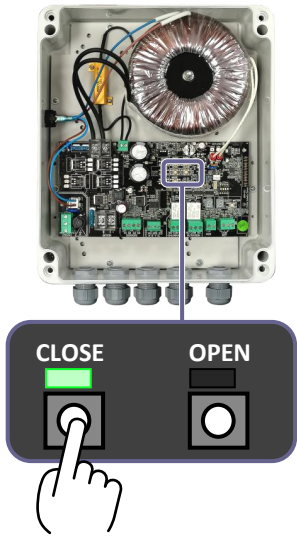

- New or reset electrical panel



- In normal operation: displays the selected motor



- When operating the cover: displays the current consumed by the motor in amperes.
- In the event of a problem: there are various alarms for specific actions.

ALARMS

OVERLOAD



- ☐ Check that nothing is blocking the cover
- ☐ Check the safety straps
- ☐ Check motor selection
- ☐ Check the power cable cross-section ([see p.24](#))
- ☐ Check water level

Reset : activate the command

If the problem persists, contact your dealer.

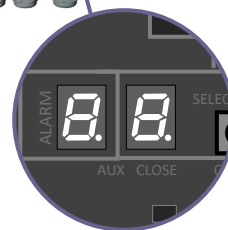

WATER LEVEL



- ☐ Fill the pool if water level sensor installed
- ☐ Shunt the AUX input if not in use

Reset : Automatic

If the problem persists, contact your dealer.

SHORT-CIRCUIT



- ☐ Short-circuit in motor power supply
- ☐ Check motor power supply wiring
- ☐ Check for the presence of insulating gel and the absence of water in the junction box

Reset : Switch the electrical panel off and on again

If the problem persists, contact your dealer.

LIMIT SWITCH WIRING/SENSOR



- ☐ Check the 24VDC fuse
- ☐ Check wiring ([see p.24](#))
- ☐ Check for the presence of insulating gel and the absence of water in the junction box
- ☐ Check the condition of the motor power cable

Reset : Adjust the limit switches

If the problem persists, contact your dealer.



Warning:

Read the instructions carefully before operating the power supply unit .



Electrical hazard:

Turn off the power supply unit before performing any wiring.



: Alternating current



: Direct current



Electrical protection Class 2 :

The device has double insulation with no accessible metal parts.



European compliance:

Fluidra is committed to the conformity of its product with European legislation, particularly in regard to safety, health and environmental protection.



Waste Electrical and Electronic Equipment (WEEE):

Relates to the reel and the power supply unit.

- Do not throw the product **in the dustbin or in municipal recycling containers.**
- It is possible to:
 - Take the used equipment the local dump/recycling centre.
 - Donate the equipment to an NGO.
 - Return the equipment to the retailer when purchasing a new one.

CERTIFICAT DE CONFORMITE / CERTIFICATE OF CONFORMITY

SGS SERCOVAM certifie que les échantillons et la documentation fournis par la société FLUIDRA INDUSTRY France pour le tablier de volet roulant PVC de largeur minimale 2.0 mètres et identifiés par la société SGS SERCOVAM sous le numéro PE 172712B ont subi les tests et/ou analyses décrits ci-après.

SGS SERCOVAM Tests Laboratory certifies that the samples provided by the company FLUIDRA INDUSTRY France for the curtain of roller shutter PVC with a minimal width of 2.0 meters, referenced under SGS SERCOVAM number PE 172712B, were tested and/or analysed following the descriptions below.

Type / Type: Tablier de volet roulant PVC / Curtain of roller shutter PVC
Modèles de volet roulant concernés / Roller shutter models concerned :
 Alpha, Bahia, Altea, Roussillon, N-Carlit, Carlit, Carlit Solaire, Capcir, Capcir solaire, Vallespir
Largeur du bassin / Width of the basin : 2.00 m
Fabricant / Manufacturer : FLUIDRA INDUSTRY FRANCE
Demandeur / Applicant : FLUIDRA INDUSTRY FRANCE - 66000 PERPIGNAN

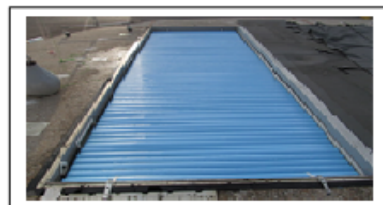

Type de l'essai / Test type	Méthode d'essai/Norme / Test method/Norm
1. Essais et/ou analyses en laboratoire 2. Essais sur site en configuration réelle	NF-ISO-EN-CEI NFP90-308 (12/2013) :
Conclusion / Conclusion Au vu du rapport d'essais SGS SERCOVAM en date du 07/12/2017 Réf. RES 172712B, le volet roulant et sa documentation sont conformes aux exigences de sécurité de la Norme NF-ISO-EN-CEI NFP90-308 (12/2013). On the basis of the results contained in the report reference Res 172712B (2017/12/07), the roller shutter tested is declared in conformity with the requirements of the standard NF-ISO-EN-CEI NFP90-308 (2013-12)	Cyril JOLFRE Chef d'Unité MECA Pr MECA Pr Unit manager 

- L'attestation a été établie au regard du(es) rapport(s) d'essais référencés ci-dessus. Ces rapports ont été élaborés entre autre sur la base d'informations, de documents/rapports d'essais de laboratoires de contrôle tiers, certificats et/ou d'échantillons, garanties fournis par le Client ou pour son compte, et pour le seul intérêt de celui-ci qui décide seul de l'usage qu'il entend faire des Rapports. Ni SGS SERCOVAM ni aucun de ses dirigeants, employés, agents ou sous-traitants ne sera responsable envers FLUIDRA INDUSTRY France ou envers un tiers d'actions engagées ou non engagées sur la base de ladite attestation, desdits rapports ou de résultats incorrects en cas de non-conformité d'un ou des éléments du(des) produit(s) que SGS SERCOVAM n'a pas testé(s) provenant d'informations, documents, rapports d'essais tiers ou de garanties de FLUIDRA INDUSTRY France de la conformité d'un ou des éléments du(des) produit(s) aux normes en vigueur, peu claires, erronées, incomplètes, équivoques ou fausses fournies à la Société.
- Les échantillon(s) auxquels se rapportent les constatations reportées dans le(s) Rapports d'essais (les « Constatations ») a été(s) prélevé(s) par le Client ou par un tiers agissant pour le Client. Les Constatations ne constituent aucune garantie de représentativité de l'échantillon par rapport à une marchandise quelconque et ne se rapportent qu'à l'échantillon concerné. La Société n'a aucune responsabilité s'agissant de la marchandise d'origine ou de la source dont le(s) échantillon(s) est/sont déclaré(s) provenir.
- Elle n'implique en aucun cas qu'une procédure de surveillance ou de contrôle de fabrication ait été mise en place par SGS SercoVam.
- La conformité à la norme référencée ci-dessus n'exonère en aucun cas le Client de sa responsabilité au regard de la conformité du(des) produit(s) à la réglementation en vigueur.
- Des copies peuvent être délivrées sur simple demande auprès du demandeur. SGS SERCOVAM ne reconnaît aucune reproduction partielle du certificat fourni. SGS SERCOVAM reconnaît, pour les certificats émis au format papier, les reproductions intégrales des certificats (sous forme de fac-similé photographique uniquement), fidèles et en tous points conformes à l'original du certificat certifié électroniquement conservé en ses locaux.
- En cas de litige, seul le fichier du certificat certifié électroniquement conservé par SGS SERCOVAM fait foi. Par ailleurs, seule la partie du certificat rédigée en français prévaudra.
- Ce document est émis par la Société conformément à ses Conditions Générales de Service accessibles en français sur http://www.sgs.com/terms_and_conditions_service_fr.htm. Votre attention est attirée sur les clauses de limitation de responsabilité, indemnisation et compétence qui y sont définies.

- The certificate was established from test report(s) above mentioned. These test reports were issued among basis of information, documents/test reports from third control laboratories, certificates and/or samples, guarantees provided by the Customer or on his behalf and for the sole interest of the customer who decides alone what to use reports. Neither SGS SERCOVAM company nor any of its officers, employees, agents or subcontractors shall be liable to PISCINES FLUIDRA INDUSTRY France or to any third party for actions engaged or not engaged on basis of this certificate, reports or incorrect results in case of non-compliance concerning one of elements from product(s) untested by SGS SERCOVAM coming from information, documents, third test reports or guarantees from FLUIDRA INDUSTRY France from compliance of one or several elements from product(s) with standard in force, unclear, incorrect, incomplete, ambiguous or false norms provided by the company.
- The/ sample (s) that relate the observations reported in test reports (section Observations) was /were taken by the customer or by a third party acting for the customer. The observations do not constitute a representative sample of the guarantee in relation to any goods and relate only to the sample in question. The company has no liability with regard to the origin of goods or the source from which the/ sample (s) is/are declared coming from.
- It does not imply that SGS SERCOVAM has performed any watching process or manufacturing control.
- The conformity to the above-referenced standard does not exempt the customer from the rules in force.
- Copies are available upon request by the applicant. SGS SERCOVAM does not recognize any partial reproduction of the certificate. SGS SERCOVAM acknowledges: concerning the certificates issued in paper format the reproduction of certificates (in the form of photographic facsimile only), and faithful in all respects in accordance with the original copy of the digitally-certified certificate saved in its facilities.
- In case of litigation, only the file from the digitally certified certificate saved by SGS SERCOVAM will be considered as being the authentic version. Only the French part of the certificate will be considered as being also the authentic version.
- This document is emitted by the Company in conformity with its own General Terms of Service available in French language via http://www.sgs.com/terms_and_conditions_service_fr.htm. Your attention is drawn to the limitation of liability clauses, compensation and competency stated in this document.

ERQ/PROD-DO-131 A Page 1/1

SGS SERCOVAM | BP 10 – ZI Marticot 33611 Cestas, France | t +33 (0)5 57 97 02 33 | f +33 (0)5 57 83 53 73 | www.sercovam.com | www.sgs.com

Membre du Groupe SGS (SGS SA)

Siège social : 21 chemin de Marticot - SAS au capital de 407 085 € - APE 7120B - Siret 341 929 925 00020 - N°TVA Intracommunautaire : FR43 341 929 925

CERTIFICAT DE CONFORMITE / CERTIFICATE OF CONFORMITY

SGS SERCOVAM certifie que les échantillons et la documentation fournis par la société FLUIDRA INDUSTRY France pour le tablier de volet roulant PC de largeur minimale 2.0 mètres et identifiés par la société SGS SERCOVAM sous le numéro PE 172712A ont subi les tests et/ou analyses décrits ci-après.

SGS SERCOVAM Tests Laboratory certifies that the samples provided by the company FLUIDRA INDUSTRY France for the curtain of roller shutter PC with a minimal width of 2.0 meters, referenced under SGS SERCOVAM number PE 172712A, were tested and/or analysed following the descriptions below.

Type / Type: Tablier de volet roulant PC / Curtain of roller shutter PC

Modèles de volet roulant concernés / Roller shutter models concerned :

Alpha, Bahia, Altea, Roussillon, N-Carlit, Carlit, Carlit Solaire, Capcir, Capcir solaire, Vallespir

Largeur du bassin / Width of the basin : 2.00 m

Fabricant / Manufacturer : FLUIDRA INDUSTRY FRANCE

Demandeur / Applicant : FLUIDRA INDUSTRY FRANCE - 66000 PERPIGNAN



Type de l'essai / Test type	Méthode d'essai/Norme / Test method/Norm
1. Essais et/ou analyses en laboratoire 2. Essais sur site en configuration réelle	NF-ISO-EN-CEI NFP90-308 (12/2013) :
Conclusion / Conclusion Au vu du rapport d'essais SGS SERCOVAM en date du 07/12/2017 Réf. RES 172712A, le volet roulant et sa documentation sont conformes aux exigences de sécurité de la Norme NF-ISO-EN-CEI NFP90-308 (12/2013). On the basis of the results contained in the report reference Res 172712A (2017/12/07), the roller shutter tested is declared in conformity with the requirements of the standard NF-ISO-EN-CEI NFP90-308 (2013-12)	Cyril JOLFRE Chef d'Unité MECA Pr MECA Pr Unit manager 

- L'attestation a été établie au regard du(les) rapport(s) d'essais référencés ci-dessus. Ces rapports ont été élaborés entre autre sur la base d'informations, de documents/rapports d'essais de laboratoires de contrôle tiers, certificats et/ou d'échantillons, garanties fournis par le Client ou pour son compte, et pour le seul intérêt de celui-ci qui décide seul de l'usage qu'il entend faire des Rapports. Ni SGS SERCOVAM ni aucun de ses dirigeants, employés, agents ou sous-traitants ne sera responsable envers FLUIDRA INDUSTRY France ou envers un tiers d'actions engagées ou non engagées sur la base de ladite attestation, desdits rapports ou de résultats incorrects en cas de non-conformité d'un ou des éléments du(des) produit(s) que SGS SERCOVAM n'a pas testé(s) provenant d'informations, documents, rapports d'essais tiers ou de garanties de FLUIDRA INDUSTRY France de la conformité d'un ou des éléments du(des) produit(s) aux normes en vigueur, peu claires, erronées, incomplètes, équivoques ou fausses fournies à la Société.
- Les échantillon(s) auxquels se rapportent les constatations reportées dans le(les) Rapports d'essais (les « Constatations ») a (ont été(s) prélevé(s) par le Client ou par un tiers agissant pour le Client. Les Constatations ne constituent aucune garantie de représentativité de l'échantillon par rapport à une marchandise quelconque et ne se rapportent qu'à l'échantillon concerné. La Société n'a aucune responsabilité s'agissant de la marchandise d'origine ou de la source dont le(les) échantillon(s) est/sont déclaré(s) provenir.
- Elle n'implique en aucun cas qu'une procédure de surveillance ou de contrôle de fabrication ait été mise en place par SGS Sercovam.
- La conformité à la norme référencée ci-dessus n'exonère en aucun cas le Client de sa responsabilité au regard de la conformité du(des) produit(s) à la réglementation en vigueur.
- Des copies peuvent être délivrées sur simple demande auprès du demandeur. SGS SERCOVAM ne reconnaît aucune reproduction partielle du certificat fourni. SGS SERCOVAM reconnaît, pour les certificats émis au format papier, les reproductions intégrales des certificats (sous forme de fac-similé photographique uniquement), fidèles et en tous points conformes à l'original du certificat certifié électroniquement conservé en ses locaux.
- En cas de litige, seul le fichier du certificat certifié électroniquement conservé par SGS SERCOVAM fait foi. Par ailleurs, seule la partie du certificat rédigée en français prévaudra.
- Ce document est émis par la Société conformément à ses Conditions Générales de Service accessibles en français sur http://www.sgs.com/terms_and_conditions_service_fr.htm. Votre attention est attirée sur les clauses de limitation de responsabilité, indemnisation et compétence qui y sont définies.

- The certificate was established from test report(s) above mentioned. These test reports were issued among basis of information, documents/test reports from third control laboratories, certificates and/or samples, guarantees provided by the Customer or on his behalf and for the sole interest of the customer who decides alone what to use reports. Neither SGS SERCOVAM company nor any of its officers, employees, agents or subcontractors shall be liable to PISCINES FLUIDRA INDUSTRY France or to any third party for actions engaged or not engaged on basis of this certificate, reports or incorrect results in case of non-compliance concerning one of elements from product(s) untested by SGS SERCOVAM coming from information, documents, third test reports or guarantees from FLUIDRA INDUSTRY France from compliance of one or several elements from product(s) with standard in force, unclear, incorrect, incomplete, ambiguous or false norms provided by the company.
- The/ sample (s) that relate the observations reported in test reports (section Observations) was/were taken by the customer or by a third party acting for the customer. The observations do not constitute a representative sample of the guarantee in relation to any goods and relate only to the sample in question. The company has no liability with regard to the origin of goods or the source from which the/ sample (s) is/are declared coming from.
- It does not imply that SGS SERCOVAM has performed any watching process or manufacturing control.
- The conformity to the above-referenced standard does not exempt the customer from the rules in force.
- Copies are available upon request by the applicant. SGS SERCOVAM does not recognize any partial reproduction of the certificate. SGS SERCOVAM acknowledges: concerning the certificates issued in paper format: the reproduction of certificates (in the form of photographic facsimile only), and faithful in all respects in accordance with the original copy of the digitally-certified certificate saved in its facilities.
- In case of litigation, only the file from the digitally certified certificate saved by SGS SERCOVAM will be considered as being the authentic version. Only the French part of the certificate will be considered as being also the authentic version.
- This document is emitted by the Company in conformity with its own General Terms of Service available in French language via http://www.sgs.com/terms_and_conditions_service_fr.htm. Your attention is drawn to the limitation of liability clauses, compensation and competency stated in this document.

ERQ/PROD-DO-131 A Page 1/1



FLUIDRA INDUSTRY FRANCE

105 Rue Henry Potez
66000 Perpignan - FRANCE

COUVERTURE DE SÉCURITÉ AUTOMATIQUE POUR PISCINE
AUTOMATIC SAFETY COVER FOR SWIMMING POOL
CUBIERTA DE SEGURIDAD AUTOMÁTICA PARA PISCINA
COBERTURA DE SEGURANÇA AUTOMÁTICA PARA PISCINA
COPERTURA AUTOMATICA DI SECUREZZA PER PISCINA
AUTOMATISCHE SICHERHEITSABDECKUNG FÜR SCHWIMMBAD
AUTOMATISCHE VEILIGHEIDSAFDEKKING VOOR ZWEMBAD
AUTOMATISKT POOLSKYDD

OCTÉO / BELLASUN / ZEN'IT / ZEN'IT SOLAIRE / BAHIA RAIL / BORNE / SVELTÉA / ULMO / IBATOP / ROUSSILLON



DECLARATION DE CONFORMITÉ

Les produits énumérés ci-dessus sont conformes aux prescriptions de sécurité des Directives Européennes :

- Machines (2006/42/CE)
- Compatibilité électromagnétique (2014/30/UE)
- Basse tension (2014/35/UE)



DECLARATION OF CONFORMITY

The products listed above comply with the safety requirements of the European Directives:

- Machine (2006/42/CE)
- Electromagnetic Compatibility (2014/30/UE)
- Low-Voltage (2014/35/UE)



DECLARACIÓN DE CONFORMIDAD

Los productos enumerados arriba cumplen con los requisitos de seguridad de las Directivas Europeas:

- Máquinas (2006/42/CE)
- Compatibilidad electromagnética (2014/30/UE)
- Baja tensión (2014/35/UE)



DECLARAÇÃO DE CONFORMIDADE

Os produtos acima enumerados cumprem os requisitos de segurança das Diretivas Europeias:

- Máquinas (2006/42/CE)
- Compatibilidade electromagnética (2014/30/UE)
- Baixa tensão (2014/35/UE)



DICHIARAZIONE DI CONFORMITÀ

I prodotti elencati sono conformi alle prescrizioni di sicurezza delle Direttive Europee:

- Macchine (2006/42/CE)
- Compatibilità elettromagnetica (2014/30/UE)
- Bassa tensione (2014/35/UE)



KONFORMITÄTSERKLÄRUNG

Die oben aufgeführten Produkte, entsprechen den Sicherheitsbestimmungen der europäischen Richtlinien:

- Maschinenrichtlinie (2006/42/EG)
- Elektromagnetische Verträglichkeit (2014/30/EU)
- Niederspannung (2014/35/EU)



CONFORMITEITSVERKLARING

De hierboven genoemde producten voldoen aan de veiligheidsvoorschriften van de Europese richtlijnen:

- Machinerichtlijn (2006/42/EG)
- Elektromagnetische compatibiliteit (2014/30/EU)
- Laagspanning (2014/35/EU)



INTYG OM ÖVERENSSTÄMMELSE

De ovan angivna produkterna uppfyller säkerhetskraven i följande EU-direktiv:

- Maskindirektivet (2006/42/EG)
- Direktivet om elektromagnetisk kompatibilitet (2014/30/EU)
- Lågspänningsdirektivet (2014/35/EU)

Stéphane FIGUEROA
General Manager
10 - 2021

In order to ascertain that the installation complies with NF P 90-308, please ensure that:

- ☐ It is possible to see all the pool during operation and to ensure there is nobody in the pool when the cover is being closed.
- ☐ The control unit requires continuous contact during closing.
- ☐ The control unit can be locked away.
- ☐ The security straps are correctly installed (number and positioning) and easy to manipulate.
- ☐ The distance between the slats and the pool wall is less than 7cm throughout the length of the pool.
- ☐ The cover can be unrolled and rolled up correctly.
- ☐ The cover covers the entire pool, with no gaps.
- ☐ The pool is not overflowing.
- ☐ The width of the pool is 2m or over.
- ☐ For Roman steps and other unconventional shapes, it should not be possible to pass a 70mm x 250mm x 10mm thick gauge between the interior wall of the pool and the edge of the cover when placed flat against the ends of the cover.
- ☐ If there is a remote control, check that standard requirements are met ([see p.35](#)).

Your installer/retailer confirms that the cover installation complies with the NF P 90-308 standard.

Signature:

Date:

Name:

Contact details:

SAFETY ADVICE

GENERAL SAFETY ADVICE

WARNING:

The pool may expose your children to significant risk. Drowning can occur very rapidly. Children near the pool require your constant vigilance and must be supervised at all times, even if they know how to swim.

Learn what you can do to save lives.

Memorise the first aid telephone numbers and post the information next to the pool.



FIRE SERVICE : ...

AMBULANCE : ...

Closest poison control center : ...

A responsible adult must be present at all times when the pool is open.

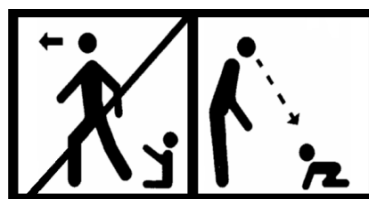

SAFETY ADVICE FOR USE OF COVERS

WARNING :

Note carefully that safety is only assured when the cover is closed, fastened, and has been correctly installed according to manufacturer's instructions.

- This cover is not a substitute for common sense or for individual responsibility. Its purpose is not to substitute the vigilance of parents and/or responsible adults, who remain essential for the protection of young children.
- The cover must always be closed when the owner is away from home, even if only for a moment.
- Opening and closing of the cover must only be carried out by a responsible adult.
- Check that there are no swimmers or foreign bodies in the pool before, during and after operation.
- Keep cover operation equipment well out of reach of children.
- Climbing, walking, or jumping onto the security cover is strictly forbidden.
- When a malfunction has been noted that prevents the closing of the cover and risks the safety of the pool, or if the equipment or the pool is temporarily unavailable, adopt all the necessary measures to prevent access to the pool until the cover has been repaired.
- Respect recommended water levels.

FLUIDRA

ORIGINAL INSTRUCTIONS. WE RESERVE THE RIGHT TO MODIFY ALL OR PART OF THE CHARACTERISTICS OF OUR ARTICLES OR THE CONTENT OF THIS DOCUMENT WITHOUT PRIOR WARNING.